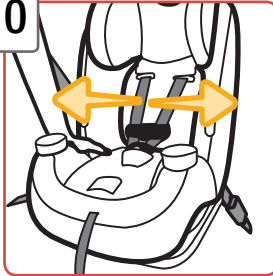

10

**Check Belt Tightness**

Hold at the **Forward-Facing Belt Path**.

Push and pull from side to side.

It should not move more than **1 in. (2.5 cm)**.



up to 65 lb (29 kg)



up to 40 lb (18 kg)

Finished!

Check the tightness of the install often.



For information on child fit and how to secure your child in the car seat, please review the full instruction manual.



MAXI-COSI[®]
We carry the future

Pria 3-in-1 Convertible Car Seat

Quick Start Installation Guide



4358-7730 3.15.19

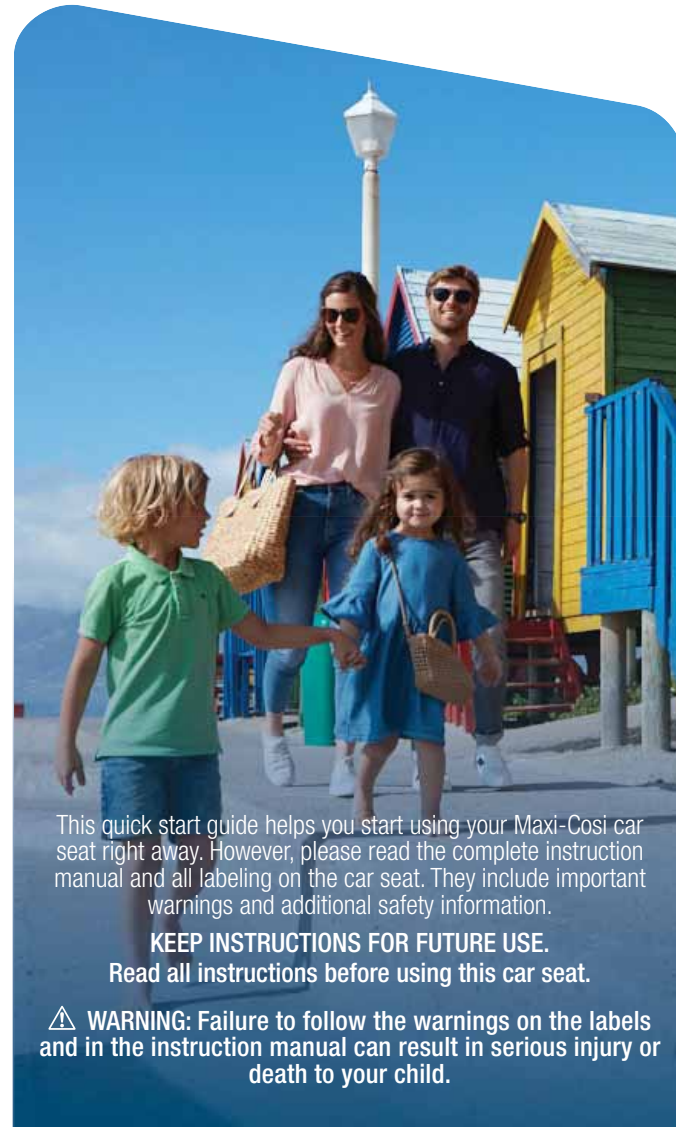

This quick start guide helps you start using your Maxi-Cosi car seat right away. However, please read the complete instruction manual and all labeling on the car seat. They include important warnings and additional safety information.

KEEP INSTRUCTIONS FOR FUTURE USE.

Read all instructions before using this car seat.

⚠️ WARNING: Failure to follow the warnings on the labels and in the instruction manual can result in serious injury or death to your child.

1

Car Seat Use Requirements

⚠️ WARNING

Measure your child's weight and height (do not guess) before choosing the car seat's mode.

This Quick Start Guide is set up to help you get started installing either the 1st or 2nd mode: **Rear-Facing** or **Forward-Facing**.

For **Booster Seat** mode and other information about choosing car seat modes, please read the full instruction manual.



REAR-FACING MODE

4-40 lb (1.8-18 kg)
and 19-40 in. (48-101.6 cm)

Children under 1 year of age must ride **Rear-Facing**.

In this car seat, your child can remain **Rear-Facing** until they outgrow any one of the following:

- **Weight Limit:** 40 lb (18 kg); **OR**
- **Height Limit:** 40 in. (101.6 cm); **OR**
- **Rear-Facing** child fit requirements. See page 11 of manual.



FORWARD-FACING MODE

22-65 lb (10.1-29 kg)
and 29-49 in. (73.6-125 cm)

Children must be at least 1 year of age to ride **Forward-Facing**.

In this car seat, your child can remain harnessed **Forward-Facing** until they outgrow any one of the following:

- **Weight Limit:** 65 lb (29 kg); **OR**
- **Height Limit:** 49 in. (125 cm); **OR**
- **Forward-Facing** child fit requirements. See page 12 of manual.

Rear-Facing Vehicle Install

2

There are 2 methods for install. Choose only one:

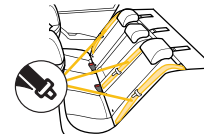

Vehicle Belt



LATCH:
Lower Anchor Belt

OR

⚠️ Do not use both the LATCH: lower anchor belt and vehicle belt at the same time. When used correctly, the LATCH: lower anchor belt or vehicle belts are equally safe.

1

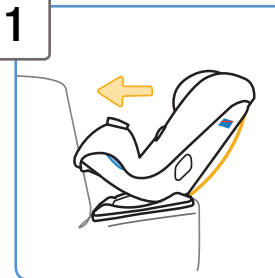

Place Car Seat Rear-Facing in Back Seat



⚠️ Never install a rear-facing child restraint in the front seat of a vehicle equipped with an active frontal airbag.

2

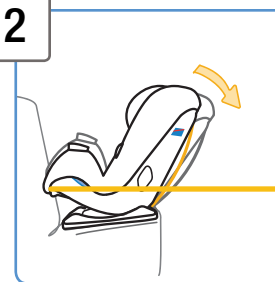

Fully Recline Car Seat

Recline handle on front of seat and under pad.

continued on next page

3

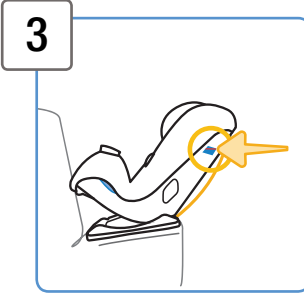

Check Rear-Facing Level Line

For children who cannot sit up unassisted, the level line **must** be parallel with the ground.

For children who can sit up unassisted, you may rotate the child restraint to be more upright in Position 2.

4

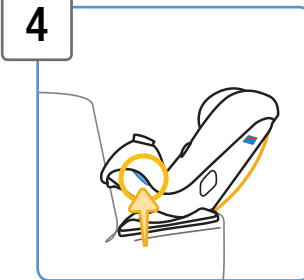

Locate Rear-Facing Belt Path

5

Review Your Vehicle Owner's Manual



Determine what kind of vehicle belt you have and how to lock a child restraint in place.

OR



Determine where designated LATCH: lower anchor seating positions are located in your vehicle.

4

6

Route Belt into Rear-Facing Belt Path

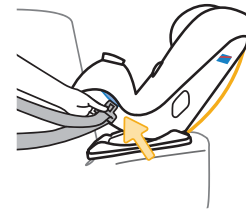

Vehicle Belt

OR

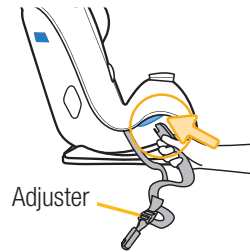

Lower Anchor Belt

Connector without the adjuster closest to it goes through the **Rear-Facing Belt Path** opening as shown.

7

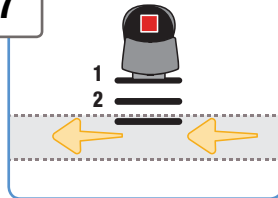

Do not twist belt.

Vehicle Belt or Lower Anchor Belt Goes:

- across car seat
- under car seat pad
- in front of buckle
- out other **Rear-Facing Belt Path** opening.

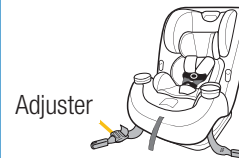

Finished Lower Anchor Belt Routing

continued on next page

5

8

Secure Car Seat in Vehicle

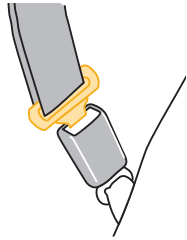

Buckle Vehicle Belt

OR

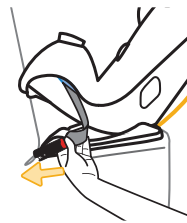

Attach Lower Anchor Belt Connectors to Vehicle's Anchors in Seat Bight

Arrows on connectors face up.

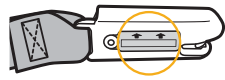

9

Tighten Belt

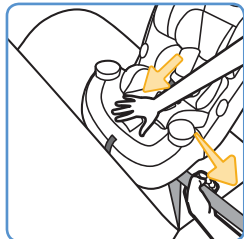

Vehicle Belt

OR

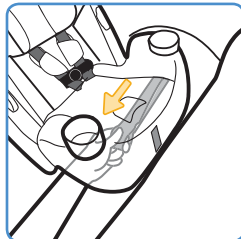

Lower Anchor Belt

6

10

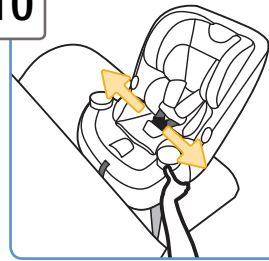

Check Belt Tightness

Hold at the **Rear-Facing Belt Path**.

Push and pull from side to side.

It should not move more than **1 in.** (2.5 cm).

11

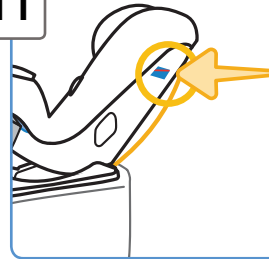

Recheck Rear-Facing Level Line

Redo the installation if the car seat is not reclined correctly for your child.



Finished!

Check the tightness of the install often.



For information on child fit and how to secure your child in the car seat, please review the full instruction manual.

7

Forward-Facing Vehicle Install

There are 2 methods for install. Choose only one:

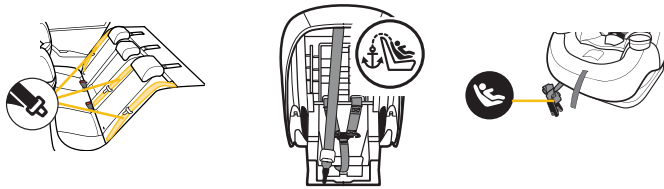

Vehicle Belt + Tether
up to 65 lb (29 kg)

OR

LATCH: Lower Anchor
Belt + Tether
up to 40 lb (18 kg)

⚠ Do not use both the LATCH: lower anchor belt and vehicle belt at the same time. When used correctly, the LATCH: lower anchor belt or vehicle belts are equally safe.

1

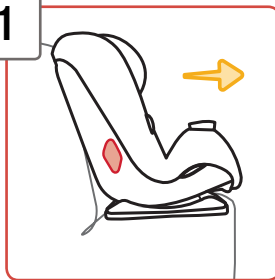

Place Car Seat Forward-Facing in Back Seat

Put the child restraint into Position 1.

Vehicle seat back must be upright.

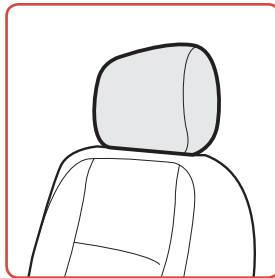

If your vehicle has a headrest that interferes with a flush car seat fit, check your vehicle owner's manual to see if it can be removed, adjusted, or if there are other possible seating locations for you to install.

8

2

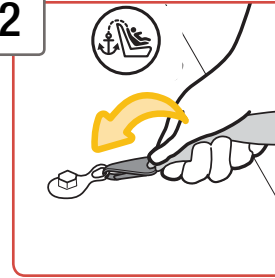

Loosely Attach Tether Hook to Vehicle's Tether Anchor

Check vehicle owner's manual for specific location.



3

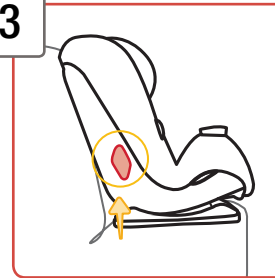

Locate Forward-Facing Belt Path

4

Review Your Vehicle Owner's Manual



Determine what kind of vehicle belt you have and how to lock a child restraint in place.

OR



Determine where designated LATCH: lower anchor seating positions are located in your vehicle.

continued on next page

5

Route Belt into **Forward-Facing** Belt Path

Vehicle Belt

OR

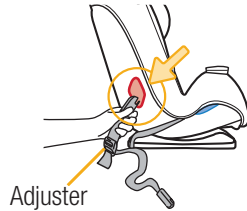

Lower Anchor Belt

Connector with the adjuster closest to it goes through the **Forward-Facing Belt Path** opening as shown.

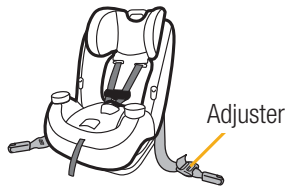

Finished Lower Anchor Belt Routing

6

Tighten Belt

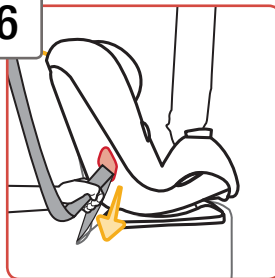

7

Tighten Tether

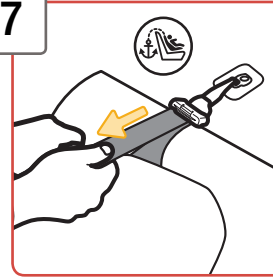

8

Secure Car Seat in Vehicle

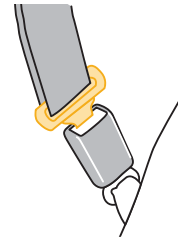

Buckle Vehicle Belt

OR

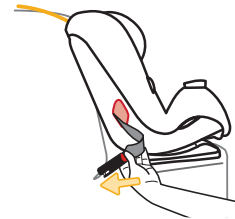

Attach Lower Anchor Belt Connectors to Vehicle's Anchors in Seat Bight

Arrows on connectors face up.

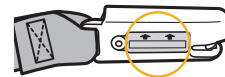

continued on next page