

COSCO®

SIMPLE

SMART

FUN

SCENERA NEXT CONVERTIBLE CAR SEAT

Rear-Facing Mode: 2.3-18 kg (5-40 lb)
and 48-102 cm (19-40 in.)

Forward-Facing Mode: 10-18 kg
(22-40 lb) and 74-110 cm (29-43 in.)
and at least 1 year old

**KEEP INSTRUCTIONS FOR FUTURE
USE.** Read all instructions before
using this car seat.

WARNING ⚠ Failure to follow the
warnings on the labels and in the
instruction manual can result in
serious injury or death to your child.

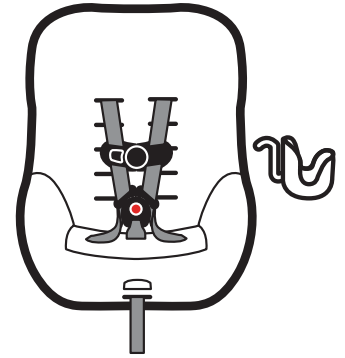

4358-7826 9.29.20

Overview

Welcome to the Cosco family and thank you for choosing this car seat, also known as a child restraint!

To help you get started using your child's new car seat, here are the 4 main tasks you'll need to complete:

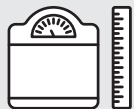

Measure Your Child



Adjust the Car Seat to Fit Your Child



Install the Car Seat into Your Vehicle



Secure Your Child in the Car Seat

Your child's safety is worth the time it will take for you to read and follow these instructions.

Ready? Let's go!

Pages 1-3 will introduce you to the parts of the car seat.

Page 68 has our contact information. If at any point you would like assistance, please feel free to reach out to us.

Quick Navigation

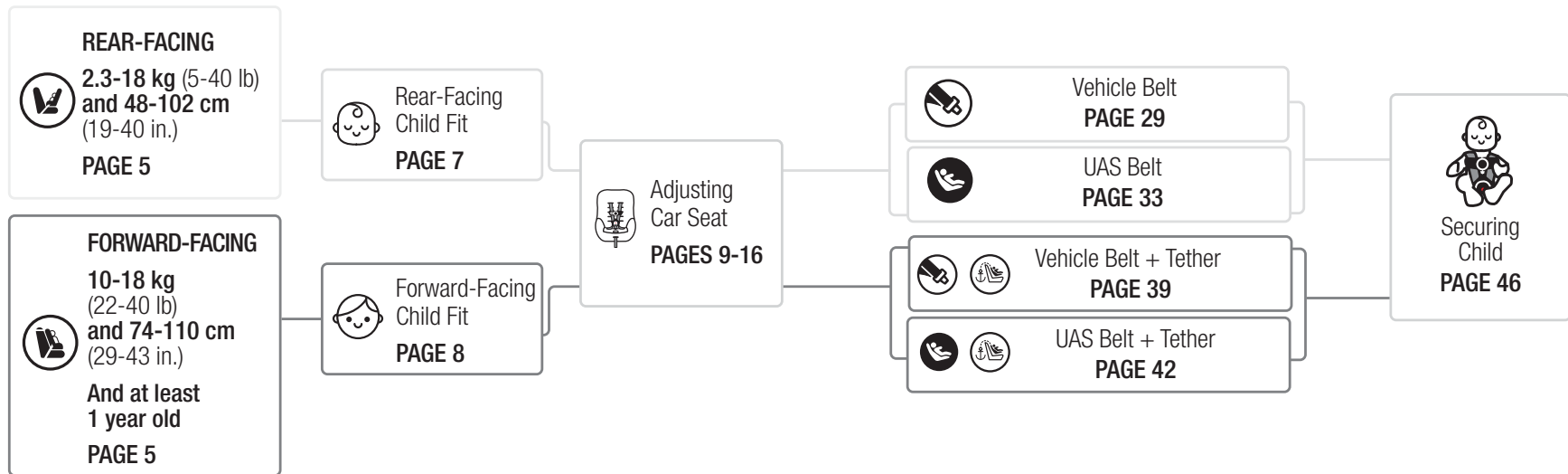

Contents

Getting Started

Parts of Car Seat 1

Accessory Use (On Select Models) . 3

Choosing Car Seat Mode 4

Preparing Car Seat for Child Fit 6

Rear-Facing Child Fit 7

Forward-Facing Child Fit 8

Making Adjustments to Car Seat

Changing Buckle Position 9

Changing Shoulder Harness Strap
Position 11

Harness System Adjustments for Smaller
Infants 13

Choosing UAS or Vehicle Belt

UAS Use 17

Vehicle Belts 20

Tether Use 25

Installation in Vehicle

Rear-Facing Mode 27

Rear-Facing Vehicle Belt Install 29

Rear-Facing UAS Belt Install 33

Forward-Facing Mode 37

Forward-Facing Vehicle Belt + Tether
Install 39

Forward-Facing UAS Belt + Tether
Install 42

Securing Child in Car Seat 46

Wash & Care of Car Seat Parts

Removing Seat Pad Set 49

Cleaning Parts of Car Seat & Installing

Seat Pad Set 50

Removing Harness System 51

Installing Harness System 53

Safety Information

Aircraft Information 57

Replacement and Expiration of Car
Seat 58

Child Restraint Use 60

Installation in Vehicle 61

Vehicle Seating Position 61

Transport Canada Regulations 62

Registration and Safety Notices 63

Additional Information

Troubleshooting 64

Warranty 65

Replacement Parts List 67

Dorel Juvenile Group Information 68

Parts of the Car Seat

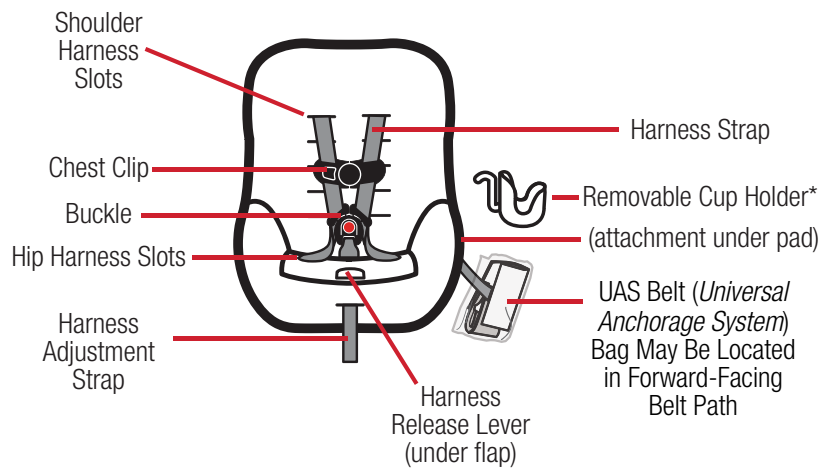

*See page 3 for Accessory Use.

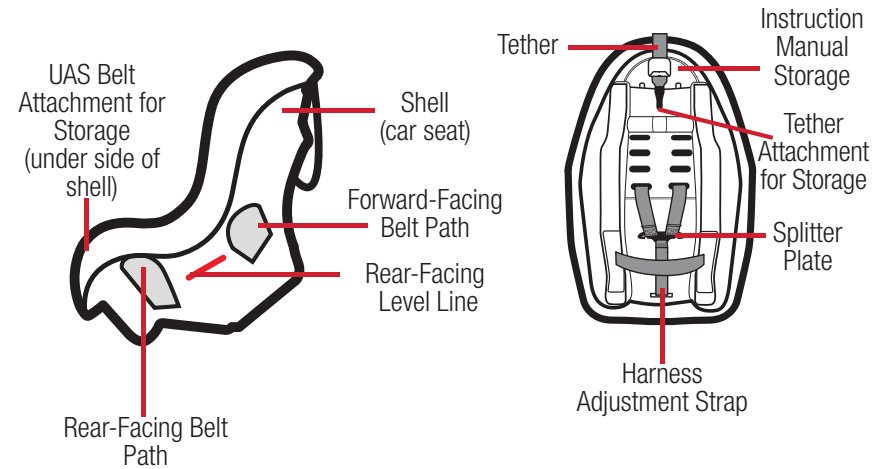

Accessory Use (On Select Models)

For Use in Rear-Facing or Forward-Facing Mode

For wash and care instructions, see page 50.

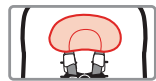

Head Pillow

To remove, from the back of the head pillow gently pull the fabric tabs out from the shoulder harness slots.

To attach, slide the fabric tabs into shoulder harness slots.



Cup Holder

The cup holder can be attached to either side of the shell. Pull pad off corner of shell. Align symbol on cup holder with symbol on shell. Hook bottom of cup holder under edge of shell. Snap top of cup holder over edge of shell. Replace pad.



Only For Use in Rear-Facing Mode



Body Pillow

To remove,
1. Loosen Harness Straps
To install,
1. Loosen Harness Straps
2. Slide It Behind Harness Straps

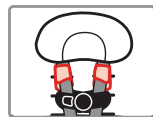

Harness Covers

To remove, pull the fastening strips apart and pull them off of the harness strap.

Choosing Car Seat Mode

⚠ Measure your child's weight and height (do not guess) before choosing the car seat's mode.

Your child's height, weight, and age determine how the car seat should be placed in the vehicle.

Children vary widely in body size, shape, and temperament—**please consult your doctor before switching between any of these modes within the limits and fit requirements of the seat.**

Provincial Laws: Please be certain to follow your province's laws regarding car seat use.

American Academy of Pediatrics Recommendations

Infants and Toddlers: Should ride in a rear-facing car seat as long as possible, until they reach the highest weight or height allowed by their seat.

Toddlers and Preschoolers: Once they are facing forward, children should use a forward-facing car seat with a harness for as long as possible, until they reach the height and weight limits for their seats.

School-Aged Children: Once they have outgrown their forward-facing car seat, children should use a belt-positioning booster seat until the vehicle's lap and shoulder seat belt fits properly. This is often when they have reached at least 4 feet 9 inches in height and are 8 to 12 years old.

continued on next page

Older Children: All children younger than 13 years should be restrained in the rear seats of vehicles for optimal protection.

REAR-FACING MODE

2.3-18 kg (5-40 lb) and 48-102 cm (19-40 in.)

Children under 1 year of age must ride **Rear-Facing**. In this car seat, your child can remain **Rear-Facing** until they outgrow any one of the following:

- **Weight Limit:** 18 kg (40 lb); **OR**
- **Height Limit:** 102 cm (40 in.); **OR**
- **Rear-Facing Child Fit** requirements, see page 7

FORWARD-FACING MODE

10-18 kg (22-40 lb) and 74-110 cm (29-43 in.)

Children must be at least 1 year of age to ride **Forward-Facing**.

In this car seat, your child can remain harnessed **Forward-Facing** until they outgrow any one of the following:

- **Weight Limit:** 18 kg (40 lb); **OR**
- **Height Limit:** 110 cm (43 in.); **OR**
- **Forward-Facing Child Fit** requirements, see page 8

Prepare Car Seat to Fit Your Child

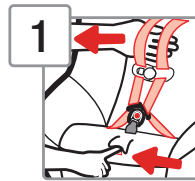

1

Fully Loosen Harness Straps

Push down on the harness release lever (through the opening in the pad)

while pulling out on the harness straps as shown.



2

Unbuckle Harness

Press in towards the **top** of the red button to release the buckle tongues.

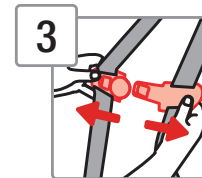

3

Release Chest Clip

Hold each side of the chest clip.

Press on the release button with your thumb and pull the chest clip apart.

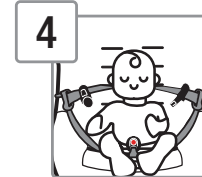

4

Place Child in Car Seat to Determine Proper Harness Fit

Your child's bottom and back should be flat against the car seat.

For **Rear-Facing** child fit, see page 7

For **Forward-Facing** child fit, see page 8.



Rear-Facing Child Fit

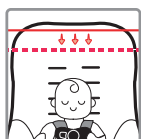

Head Position

The top of your child's head **must be at least 2.5 cm (1 in.) below** the top of the car seat.

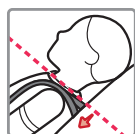

Harness Strap Position

The harness strap **must be at or slightly below** your child's shoulders; **never above.**



Buckle Position

The buckle **must be** used in either the **1st or 2nd** buckle slot.

Do not use 3rd slot in Rear-Facing mode.

Choose the slot closest to your child.

The buckle **should not be underneath or behind** your child.

Need to make adjustments?

To change buckle position, see pages 9-10.

To change harness strap position, see pages 11-12.

Forward-Facing Child Fit

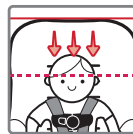

Head Position

The tops of your child's ears **must be below** the top of the car seat.

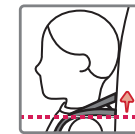

Harness Strap Position

The harness strap **must be at or slightly above** the your child's shoulders; **never below.**

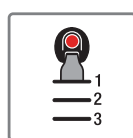

Buckle Position

The buckle can be used in **any** buckle slot. Choose the slot closest to your child.

The buckle **should not be underneath or behind** your child.

Need to make adjustments?

To change buckle position, see pages 9-10.

To change harness strap position, see pages 11-12.

Changing Buckle Position



1 Turn Car Seat Over

Locate the buckle's metal retainer on the bottom of the shell.



2 Rotate Metal Retainer and Push It Up Through Buckle Slot in Shell



3 From Top of Seat, Pull Buckle Out of Shell and Pad



4 Insert Buckle's Metal Retainer into Slot Closest to Child

The buckle **must** face out.

Rear-Facing Mode: You **must** use the 1st or 2nd buckle slot.

Forward-Facing Mode: Any slot can be used.



5 Pull Buckle's Metal Retainer Completely Through Pad and Shell



6 Check Buckle

Pull up on the buckle to make sure it is secured.

The buckle **must not** pull out.

Check your child's fit often.

If you cannot achieve a snug harness fit for your child, see pages 13-16.

To learn how to check harness tightness, see pages 46-49.

⚠ Failure to place buckle's metal retainer completely through pad and shell can result in serious injury or death.

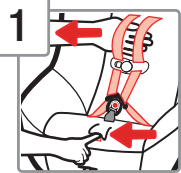

1 Fully Loosen Harness Straps

Push down on the harness release lever (through the opening in the pad) while pulling out on the harness straps as shown.



2 From Back of Car Seat, Remove Harness Straps Loops From Splitter Plate

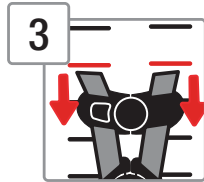

3 Pull Harness Straps Out of Shoulder Harness Slots

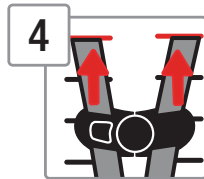

4 Rethread Harness Straps into Correct Shoulder Harness Slots For Your Child

For Rear-Facing child fit, see page 7.

For Forward-Facing child fit, see page 8.

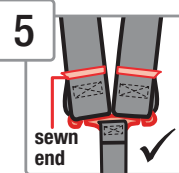

5 Attach Harness Strap Loops to Splitter Plate

The sewn ends of the harness strap loops **must** face towards you.

Do not twist the harness strap or the harness adjustment strap.

Make sure the same harness strap loops are fitted **completely on** both sides of the splitter plate.

Check your child's fit often.

If you cannot achieve a snug harness fit for your child, see pages 13-16.

To learn how to check harness tightness, see pages 46-49.

Check the harness straps often for any wear or damage.

⚠ Do not use a child restraint with damaged harness straps.

If you cannot achieve a snug harness fit for your child, you may need to adjust the buckle strap and/or harness strap length as shown in this section.

Adjusting Buckle Strap

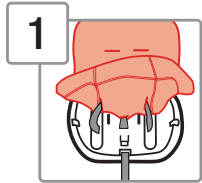

1 Pull Up Front of Seat Pad

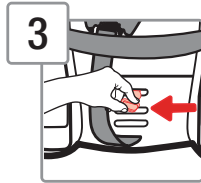

3 From Bottom of Car Seat, Pull Metal Retainer Towards You and Push It Up into Middle Slot As Shown

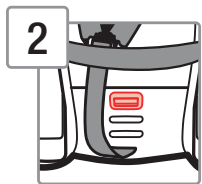

2 With Buckle in the 1st Slot As Shown, Turn Car Seat Over

If you need to move the buckle to the 1st slot, see pages 9-10.

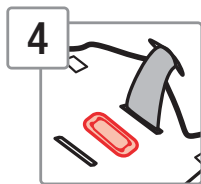

4 From Top of Car Seat, Lay the Metal Retainer Flat Against Shell As Shown



5 Check Buckle

Pull up on the buckle to make sure it is secured.

The buckle **must** not pull out.

Check your child's fit often.

To learn how to check harness tightness, see pages 46-49.

Adjusting Harness Strap

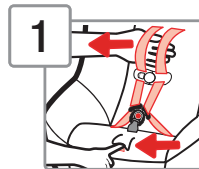

1 Fully Loosen Harness Straps



2 From Back of Car Seat, Remove Harness Strap Loops From Splitter Plate

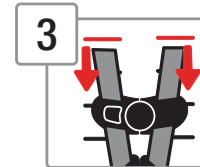

3 Pull Harness Straps Out of Shoulder Harness Slots

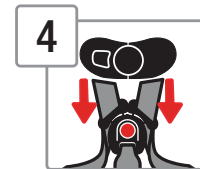

4 Unthread Chest Clip

continued on next page

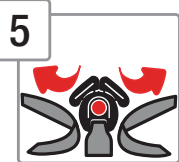

5

Unthread Buckle

Do not unbuckle.

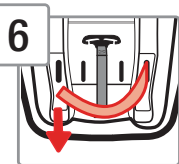

6

Lift Up Front of Seat Pad, Turn Seat Over and Pull Harness Strap Down and Out of Hip Harness Slot

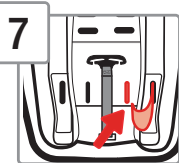

7

Weave Harness Strap In and Out of Shell as Shown

The harness strap goes behind the buckle strap.

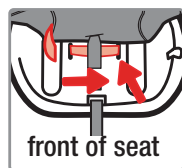

front of seat

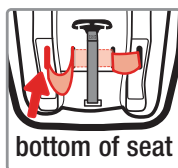

bottom of seat

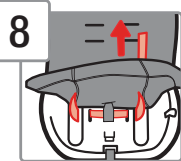

8

Thread Harness Strap Up Through Slot in Seat Pad

Replace the seat pad around the front of the shell.

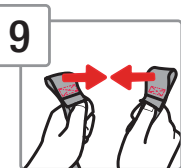

9

Make Harness Strap Even

The sewn ends of harness strap loops **must** face each other.

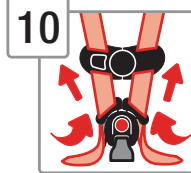

10

Thread Buckle and Chest Clip

The harness strap ends go through the **back** of the buckle tongues and through the chest clip **front to back** as shown.

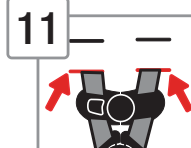

11

Thread Harness Strap Into Correct Shoulder Harness Slots for Your Child



12

Attach Harness Strap Loops to Splitter Plate As Shown

The sewn ends of the harness strap loops **must** face towards you.

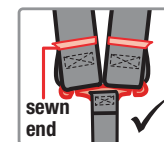

sewn end

Do not twist the harness strap or the harness adjustment strap.

Make sure the harness strap loops are fitted **completely on** both sides of the splitter plate.

Check your child's fit often.

Check the harness straps often for any wear or damage.

⚠️ Harness system must be installed correctly. Do not use a child restraint with damaged harness straps.



**For Use in Rear-Facing
or Forward-Facing Mode**

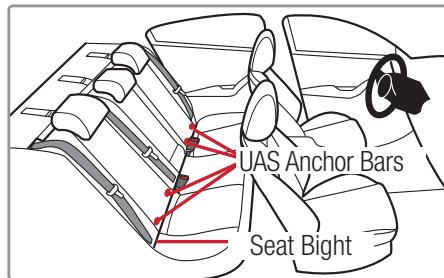

The UAS (Universal Anchorage System) is a universal system for installing child restraints without using vehicle seat belts.

The UAS can **ONLY** be used in vehicles that have the UAS bars installed in designated seating positions. Most vehicles manufactured after September 2002 are equipped with UAS bars.

Check your vehicle owner's manual to see which seating positions may be equipped with UAS bars.

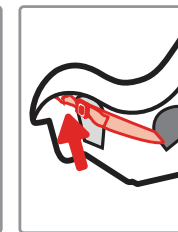
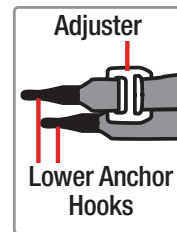

**To Remove UAS Belt from Storage Location
on Car Seat:**

Squeeze spring lever on hooks and
remove hooks from storage attachments.

**When installing this car seat with the
vehicle belts, the UAS hooks and belt must
be properly stored.**



**Do not use both the UAS belt and vehicle belt at the same time.
When used correctly the UAS belt or vehicle belts are equally safe.**

continued on next page

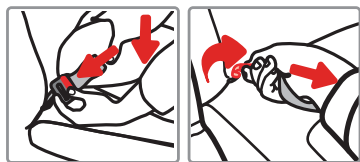

To Remove UAS Belt from Vehicle UAS Bars:

Remove tension from the belt by pushing down on side of car seat with the belt adjuster. Then press the adjuster button to loosen belt.

Unhook from anchor by squeezing spring lever on hook, pushing hook back into the seat bight, and twisting. Then pull it out of the vehicle seat.

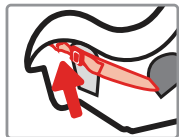

Storing UAS Belt:

When used Rear-Facing, thread UAS belt through **Forward-Facing Belt Path** as shown. Then attach hooks to attachments near **Rear-Facing Belt Path** as shown. Gently pull free end of belt to remove slack.



When used Forward-Facing, thread UAS belt through **Rear-Facing Belt Path**. Then attach hooks to attachments near **Rear-Facing Belt Path** as shown. Gently pull free end of belt to remove slack.

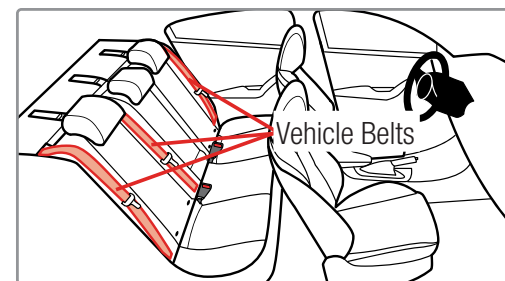

Your vehicle's features may be considerably different than those pictured here.

If UAS are not an option, you must use the vehicle seat belt system to install the car seat.

Not all vehicle belts and seating positions will work with child restraints. Please go through the following steps to understand how to lock a child restraint in Rear-Facing Mode or Forward-Facing Mode with a vehicle belt.

continued on next page



1

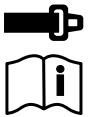

You Must Review Your Vehicle Owner's Manual

Your vehicle owner's manual will let you know which vehicle belts and seating positions car seats can be installed in.

2



Check How This Car Seat Will Be Locked Into Place

The vehicle belt **must not** loosen after tightening. This means

there needs to be a way to lock the vehicle belt.

The ways this can be done are:

- By using the seat belt's retractor, see step 3; **OR**
- By using the seat belt's latch plate, see step 4.

3

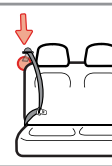

Check Retractor

Retractors pull seat belts into stored positions and lock the belt to hold passengers in place.

See the next page for some common types of vehicle belt retractors that will work with this car seat.



Types of Retractors

Switchable Retractor
(most vehicles have this type)



This retractor can be switched to a locking mode.

You **must have the retractor in the locking mode** to use the seat belt with this car seat.

Switching to locking mode: Slowly pull the shoulder belt all the way out, then let it go back in **2.5-5 cm** (1-2 in.).

As it goes back in, you will most likely hear a ratcheting sound.

Gently pull the belt to see if it has locked. You will not be able to pull any more belt out if the lock has engaged.

continued on next page



Automatic Locking Retractor



This retractor always locks.

It will automatically lock after slowly pulling the seat belt out at least halfway and letting the belt go back into the retractor **2.5-5 cm** (1-2 in.).

Emergency Locking Retractor

See Step 4, "Check Latch Plates".

If the retractor does not lock, it is most likely an Emergency Locking Retractor. These retractors only lock during a sudden stop or collision.

You will need to determine if your seat belt's latch plate can lock the belt. See step 4, "Check the Latch Plates".



Check Latch Plates

Latch plates are the part of the seat belt that goes into the buckle.

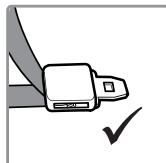

Locking Latch Plate

To see if the latch plate locks:

1. Buckle Vehicle Belt
2. Firmly Tug Lap Portion of Seat Belt While Pulling It Up



If the vehicle belt does not slide through the latch plate, it's locked.

If the latch plate slides up and down the vehicle belt, it is a **sliding latch plate**.

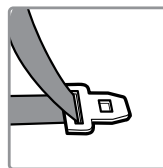

Emergency Locking Retractor with a Sliding Latch Plate

Sliding latch plates easily slip between the lap and shoulder portions of the belt.

If you have an Emergency Locking Retractor with a Sliding Latch Plate, you must use a locking clip.

Please contact us for one, see page 67.

Never Use With This Car Seat	
Emergency Locking Retractor Lap Only Belt	✗
Inflatable Seat Belts	✗



For Forward-Facing Mode Only

Your vehicle's features may be considerably different than those pictured here.

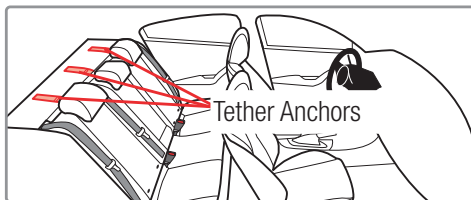

You **must always attach, adjust, and secure the tether (top anchorage) strap** when installing the car seat in the **Forward-Facing Mode** with internal harness. Tethers improve the installation and stability of car seats and reduce the risk of injury. Attach the tether hook to the tether anchor designated by your vehicle manufacturer for that seating position. Check your vehicle owner's manual for more information. If the seating position does not have a tether anchor, use a different seating position or see your dealer or a qualified mechanic and have one installed.

⚠ Using this child restraint without the tether strap anchored as required by the manufacturer would be a misuse of the child restraint and, in a sudden stop or crash, could result in serious injury or death.

Do not fasten multiple tether hooks on the same tether anchor in the vehicle.

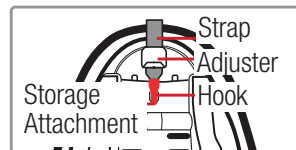

Tether Storage and Parts

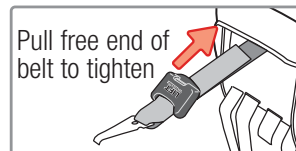

Pull free end of belt to tighten

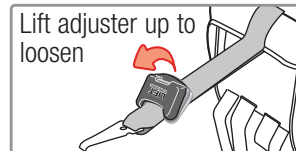

Lift adjuster up to loosen

Storing Tether Strap

When installing in the Rear-Facing Mode or when the car seat is not installed in a vehicle, attach the tether hook to its storage attachment on the back of the car seat as shown.

Gently tighten to remove slack.

Adjusting Tether Strap

To tighten: After the car seat is locked into place with the UAS belt or vehicle belt, push down on the car seat and gently pull on the free end of the tether strap.

To loosen: Lift up on the tether adjuster and push it towards the tether hook.

2.3 -18 kg (5-40 lb) and 48-102 cm (19-40 in.)



UAS Belt

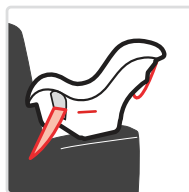

Lap Belt

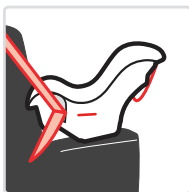

Lap/Shoulder Belt



Never install a rear-facing child restraint in the front seat of a vehicle equipped with an active frontal airbag.

Do not use the tether for rear-facing mode. Secure the tether strap hook to its storage attachment.

Do not use the UAS belt along with the vehicle lap or lap/shoulder belt.

Check the vehicle belt or the UAS belt before each use. Use only if the belt can be tightened properly and locked securely in place.

Do not fasten multiple UAS hooks on the same UAS bar in the vehicle.

Even when unoccupied, this child restraint must be firmly secured to the vehicle with a lower anchor belt or with the vehicle seat belt.

This child restraint must always face the rear of the vehicle until the child is at least 1 year old and weighs 10 kg (22 lb).



Rear-Facing Vehicle Belt Install

Before you begin installing the seat into your vehicle, did you check:

Your child's weight and height?

See page 27.

Your child's fit? See page 7.

Do you need to make adjustments to the harness height or the buckle position?

1

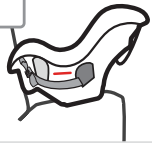

Place Car Seat Rear-Facing in Back Seat

2



Check Level Line

The level line on the shell **must** be parallel with the ground.

3



Check if Your Vehicle Belts Will Work With This Car Seat

This is very important because **not all vehicle belts will work with car seats.**

Review pages 20-24 and your vehicle owner's manual to find out what kind of vehicle belts you have and how to lock a car seat in place.

4



Route Vehicle Belt

Thread the vehicle belt into the **Rear-Facing Belt Path** opening as shown.

The belt goes:

- across the car seat; **AND**
- under the car seat pad; **AND**
- in front of the buckle; **AND**
- out the other **Rear-Facing Belt Path** opening.

Do not twist belt.

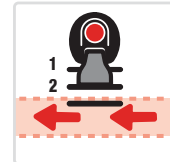

5

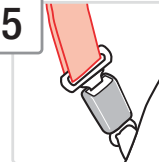

Buckle Vehicle Belt

If your car's vehicle belt has a switchable retractor, use it to lock the vehicle belt.

For information about switchable retractors, see page 22 or review your vehicle owner's manual.

6

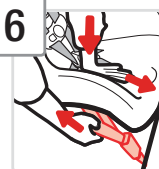

Tighten Belt

Place your hand in the car seat.

Firmly push the car seat down and back

towards the vehicle seat back while pulling the shoulder belt or the free end of lap belt parallel with the **Rear-Facing Belt Path** as shown.

continued on next page





7

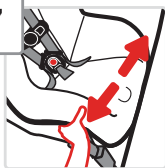

Check Belt Tightness
Hold the car seat at the **Rear-Facing Belt Path** with your weaker hand.

Push and pull the car seat from side to side. It should not move more than **2.5 cm (1 in.)**.

If it moves more than 2.5 cm (1 in.), you can try:

- Pulling the belt tighter; **OR**
- Reinstalling the car seat; **OR**
- Changing to a different seating location; **OR**
- Switching to UAS belt installation if UAS anchors are available in your vehicle

8



Secure Child in Car Seat

To properly secure your child in the car seat, see pages 46-49.

Check your child's fit often and make any needed adjustments to the car seat as they grow.

9

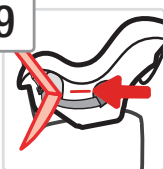

Recheck Rear-Facing Level Line
Redo the installation if the level line is not parallel with the ground.

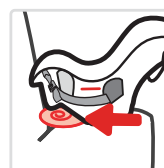

Only if necessary you may need to place a tightly rolled towel(s) or foam pool noodle(s) under the front of the car seat's base to help

get the correct recline angle for the **Rear-Facing Level Line**.

Check often to make sure padding is still in place and the belt is tight.

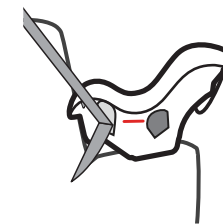

Finished!

Check the tightness of the install often to make sure it has not loosened.



Before you begin installing the seat into your vehicle, did you check:

Your child's weight and height?

See page 27.

Your child's fit? See page 7.

Do you need to make adjustments to the harness height or the buckle position?

1

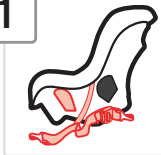

Remove UAS Belt from Storage Location

Remove it from the rear-facing belt path so both hooks are on the same side of the seat as shown.

2



Locate Rear-Facing Belt Path

Thread the hook through the **Rear-Facing Belt Path** opening as shown.

The adjuster can be on either side of the car seat.

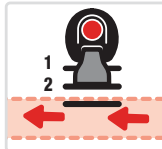

The belt goes:

- across the car seat; **AND**
- under the car seat pad; **AND**

- in front of the buckle; **AND**
- out the other **Rear-Facing Belt Path** opening.

Do not twist belt.

3

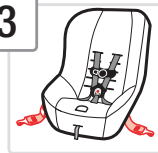

Finished UAS Belt Routing

4



Place Car Seat Rear-Facing in Back Seat

5



Check Level Line

The level line on the shell **must** be parallel with the ground.

6

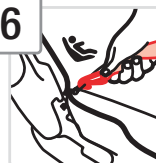

Attach UAS Hooks to Vehicle's UAS Anchors

Review your vehicle owner's manual for UAS locations and

UAS belt use.

Fasten one hook to one vehicle UAS bar.

Then repeat for the second hook on the other side of the car seat.

continued on next page





7 Tighten Belt

Place your hand in the car seat.

Firmly push the car seat down and back towards the vehicle seat back while pulling the free end of the belt parallel with the **Rear-Facing Belt Path** as shown.



It may be easier to tighten the belt by pulling back the pad and pulling the free end of the belt towards you and parallel with the belt path as shown.



8 Check Belt Tightness

Hold the car seat at the **Rear-Facing Belt Path** with your weaker hand.

Push and pull the car seat from side to side. It should not move more than **2.5 cm** (1 in.).

If it moves more than 2.5 cm (1 in.), **you can try:**

- Pulling the belt tighter; **OR**
- Reinstalling the car seat; **OR**
- Changing to a different seating location; **OR**
- Switching to vehicle belt installation



9 Secure Child in Car Seat

To properly secure your child in the car seat, see pages 46-49.

Check your child's fit often and make any needed adjustments to the car seat as they grow.

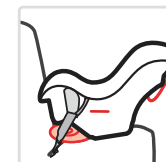

Only if necessary, you may need to place a tightly rolled towel(s) or foam pool noodle(s) under the front of the car seat's base to

help get the correct recline angle for the **Rear-Facing Level Line**.

Check often to make sure padding is still in place and the belt is tight.

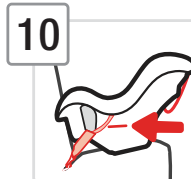

10 Recheck Level Line

Redo the installation if the level line is not parallel with the ground.

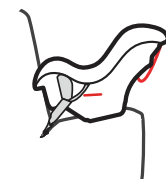

Finished!

Check the tightness of the install often to make sure it has not loosened.

**10-18 kg (22-40 lb) and 74-110 cm (29-43 in.)
and at least 1 year old**



Lower Anchor
Belt with Tether

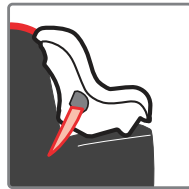

Lap Belt
with Tether

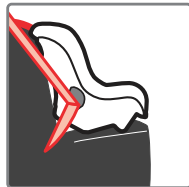

Lap/Shoulder
Belt with Tether



Do not use the UAS belt along with the vehicle lap or lap/shoulder belt. Check the vehicle belt or the UAS belt before each use. Use only if the belt can be tightened properly and locked securely in place.

Do not fasten multiple UAS hooks on the same UAS bar in the vehicle.

Even when unoccupied, this child restraint must be firmly secured to the vehicle with a UAS belt or with the vehicle seat belt.

In this child restraint your child must be at least 1 year old and weigh 10 kg (22 lb) before they sit forward-facing.



Before you begin installing the seat into your vehicle, did you check:

Your child's weight and height?

See page 37.

Your child's fit? See page 8.

Do you need to make adjustments to the harness height or the buckle position?

1

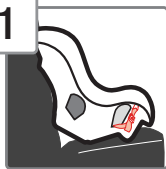

Place Car Seat Forward-Facing in Back Seat

2

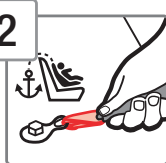

(top anchorage)

Loosely Attach Tether Hook

Check your vehicle owner's manual for specific tether anchor locations.

3



Check if Your Vehicle Belts Will Work With This Car Seat

This is very important because **not all vehicle belts will work with car seats.**

Review pages 20-24 and your vehicle owner's manual to find out what kind of vehicle belt you have and how to lock a car seat in place.

4

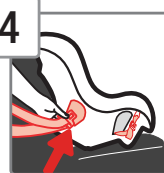

Locate the Forward-Facing Belt Path

Thread the vehicle belt through **Forward-Facing Belt Path** opening as shown.

The belt goes:

- across the car seat; **AND**
- under the car seat pad; **AND**
- out the other **Forward-Facing Belt Path** opening. **Do not twist belt.**

5

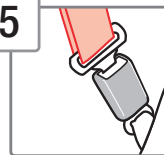

Buckle Vehicle Belt

If your car's vehicle belt has a switchable retractor, use it to lock the vehicle belt.

For information about switchable retractors, see page 22 or review your vehicle owner's manual.

6



Tighten Tether

Push firmly on the back of the car seat and pull the free end of the tether strap to remove all of the slack.

7

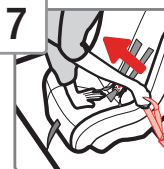

Tighten Belt

Place your hand in the car seat.

Firmly push the car seat down and back towards the vehicle seat back while pulling the shoulder belt or the free end of lap belt parallel with the **Forward-Facing Belt Path** as shown.

continued on next page





8 Check Belt Tightness

Hold the car seat at the **Forward-Facing Belt Path** with your weaker hand.

Push and pull the car seat from side to side. It should not move more than **2.5 cm** (1 in.).

If it moves more than 2.5 cm (1 in.), you can try:

- Putting your knee in the car seat and pulling the belt tighter; **OR**
- Reinstalling the car seat; **OR**
- Changing to a different seating location; **OR**
- Switching to UAS belt installation if UAS anchors are available in your vehicle



Finished!

Check the tightness of the install often to make sure it has not loosened.



Securing Child in Car Seat

To properly secure your child in the car seat, see pages 46-49.

Check your child's fit often and make any needed adjustments to the car seat as they grow.



Before you begin installing the seat into your vehicle, did you check:

Your child's weight and height?

See page 37.

Your child's fit? See page 8.

Do you need to make adjustments to the harness height or the buckle position?

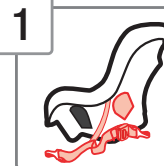

1 Remove UAS Belt from Storage Location

Remove it from the Rear-Facing Belt Path so both hooks are on the same side of the seat as shown.

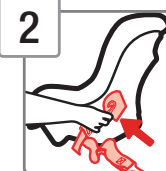

2 Locate the Forward-Facing Belt Path

Thread the belt through the **Forward-Facing Belt Path** opening as shown.

The adjuster can be on either side of the car seat.

The adjuster can be on either side of the car seat.

The belt goes:

- across the car seat; **AND**
- under the car seat pad; **AND**
- out the other **Forward-Facing Belt Path** opening.

Do not twist belt.

continued on next page

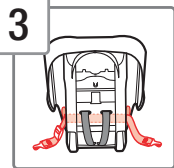

3 Finished Lower Anchor Belt Routing

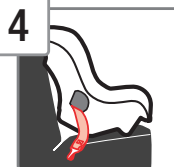

4 Place Car Seat Forward-Facing in Back Seat

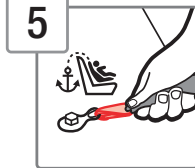

5 Loosely Attach Tether Hook

Check your vehicle owner's manual for specific tether (top anchorage) anchor locations.

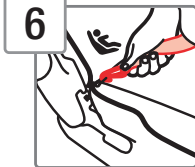

6 Attach UAS Hooks to Vehicle's UAS Anchors

Review your vehicle owner's manual for UAS locations and UAS belt use. Fasten one hook to one vehicle UAS bar. Then repeat for the second hook on the other side of the car seat.

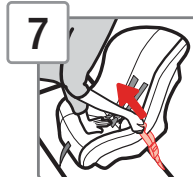

7 Tighten Belt

Place your hand in the car seat.

Firmly push the car seat down and back towards the vehicle seat back while pulling the free end of the belt parallel with the **Forward-Facing Belt Path** as shown.

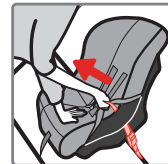

8

Tighten Tether

Push firmly on the back of the car seat and pull the free end of the tether strap to remove all of the slack.

continued on next page

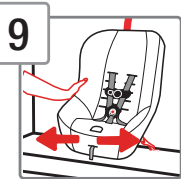

9 Check Belt Tightness

Hold the car seat at the **Forward-Facing Belt Path** with your weaker hand.

Push and pull the car seat from side to side. It should not move more than **2.5 cm (1 in.)**.

If it moves more than 2.5 cm (1 in.), you can try:

- Putting your knee in the car seat and pulling the belt tighter; **OR**
- Reinstalling the car seat; **OR**
- Changing to a different seating location; **OR**
- Switching to vehicle belt installation



Finished!

Check the tightness of the install often to make sure it has not loosened.



Securing Child in Car Seat

To properly secure your child in the car seat, see pages 46-49.

Check your child's fit often and make any needed adjustments to the car seat as they grow.



1 Place Child in Car Seat

Your child's bottom and back should be flat against the car seat.

Position the harness straps over your child's shoulders and upper thighs.



2 Buckle Harness

Push the buckle tongues into the buckle until you hear them "click".

Pull up on the harness straps to make sure the buckle is locked.

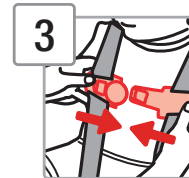

3 Fasten Chest Clip

Insert right half of the chest clip into the left half and snap together.

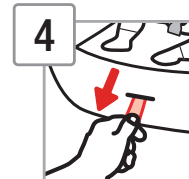

4 Tighten Harness

Pull the harness adjustment strap straight out to snugly tighten the harness system.

continued on next page



5 Position Chest Clip

Slide the chest clip up the harness straps and position it at mid-chest (even with armpits) and away from your child's neck.



6 Check Harness Tightness

Try to pinch the harness strap at the shoulder vertically between your index finger and thumb as shown.

If your fingers slip off, the harness system is tight enough. **If you can pinch the harness strap**, tighten more.

A snug strap should not allow any slack. It lies in a relatively straight line without sagging. It does not press on the child's flesh or push the child's body into an unnatural position.

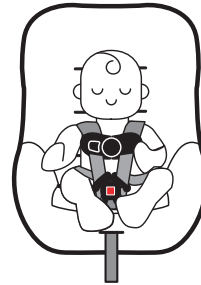

Finished!

Your child is now secured in the car seat. Check your child's fit often and make any needed adjustments to the car seat as they grow.

To Remove Child from Car Seat:

1. Loosen Harness Strap
2. Unbuckle Harness
3. Release Chest Clip
4. Remove Child

continued on next page

⚠ Failure to fasten and tighten the harness system correctly may allow the child to be ejected from the child restraint in a crash or sudden stop causing serious injury or death.

Do not mistake comfort for safety. Harness system must be snugly adjusted.



DO NOT put snowsuits or bulky garments on your child when placing them in the child restraint.

Bulky clothing can prevent the harness straps from being tightened properly.

You must remove the harness system to remove the pad from the shell. See pages 51-52.

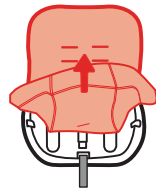

Remove Pad

Pull pad off the bottom of child restraint and remove pad.

Cleaning Seat Pad & Accessories

Machine wash separately with cold water on a gentle cycle. Do not use bleach. Tumble dry separately for 10-12 minutes on low heat. Remove immediately.

Cleaning Harness Strap

Check all straps often for any wear or damage.

Spot clean using warm sudsy water and damp cloth.

Spilled food and liquids on the car seat may result in mold or bacterial growth over time. These spills could also attract insects or rodents.

Cup Holder

The cup holder is top-rack dishwasher safe.

Cleaning Buckle, Chest Clip, Shell

Spot clean using warm sudsy water and damp cloth. Do not submerge into water.

⚠ Do not use the child restraint without the seat pad or with damaged harness straps.

Installing Seat Pad Set

Starting from the bottom of car seat, slip the pad on the shell. Pull the harness adjustment strap through the pad. Wrap the pad around the top of shell. Install the harness system, see pages 53-56.

Removing Harness System

Only remove the harness system to clean the seat pad.

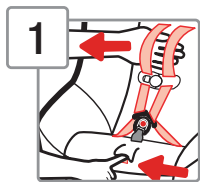

1 Fully Loosen
Harness Straps

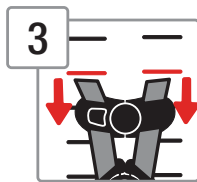

3 Pull Harness
Strap Out
of Shoulder
Harness Slots

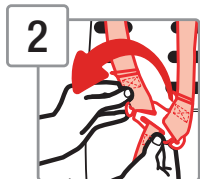

2 From Back of
Seat, Remove
Harness Strap
Loops From
Splitter Plate

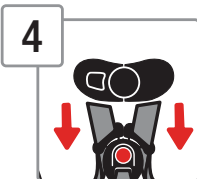

4 Unthread
Chest Clip

5

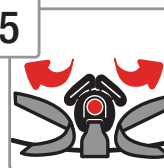

5 Unthread Buckle
Do not unbuckle.

6



6 Pull Harness
Strap Out of Car
Seat

7

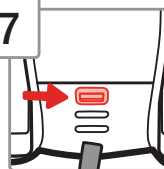

7 Turn Car Seat
Over
Locate the buckle's
metal retainer on
the bottom of the
shell.

8

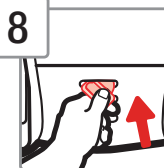

8 Rotate Metal
Retainer and
Push It Up
Through Shell
and Pad

9



9 From Top of Car
Seat, Pull Buckle
Out of Shell



1 Insert Buckle's Metal Retainer into Slot Closest to Child

The buckle **must** face out.

Rear-Facing Mode: You **must** use the 1st or 2nd buckle slot.

Forward-Facing Mode: Any slot can be used.

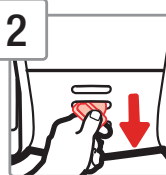

2 Pull Metal Retainer Completely Through Pad and Shell



3 Check Buckle

Pull up on the buckle to make sure it is secured.

The buckle **must** not pull out.

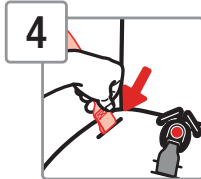

4 Rethread Harness Strap

With the sewn end of the harness strap loop facing the buckle, thread

the harness strap down through the hip harness slot.

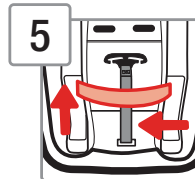

5 Pull Harness Strap Across Bottom of Shell

The harness strap **must** lie in front of the harness

adjustment strap as shown. Push the harness strap up through other the hip harness slot.

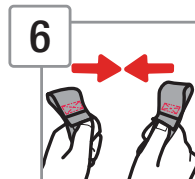

6 Make Harness Strap Even

The sewn ends of harness strap loops **must** face each other.

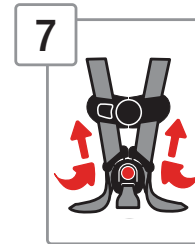

7 Thread Buckle and Chest Clip

The harness strap ends go through the **back** of the buckle tongues and through the chest clip **front to back** as shown.

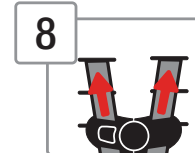

8 Thread Harness Straps Into Correct Shoulder Harness Slots For Your Child

For Rear-Facing child fit, see page 7.

For Forward-Facing child fit, see page 8.

continued on next page

9



Attach Harness Strap Loops to Splitter Plate As Shown

The sewn ends of the harness strap loops **must** face towards you.

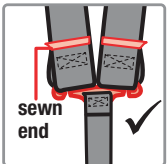

Do not twist the harness strap or the harness adjustment strap.

Make sure the harness strap loops are fitted **completely on** both sides of the splitter plate.

Check your child's fit often.

If you cannot achieve a snug harness fit for your child, you may need to adjust the harness system.

See pages 13-16.

To learn how to check harness tightness, see pages 46-49.

Check the harness straps often for any wear or damage.

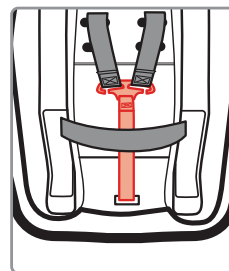

⚠ Failure to place harness adjustment strap behind the harness strap as shown can result in serious injury or death.

Do not use a child restraint with damaged harness straps.



This restraint is certified for aircraft use. Install the child restraint in a window seat to avoid blocking the aisle. If the aircraft lap belt is too short, ask the flight attendant for a belt extender.

Use only on forward facing aircraft seats. Contact the airline for their specific policies.

Some airlines may ask to see a label stating that this child restraint is certified for aircraft use.



There is an airplane certification label located on the side of this child restraint as shown.

 **Store the UAS belt and tether strap when installing with aircraft belts.**



Rear Facing Aircraft Installation

Follow the steps on pages 29-32.



Forward Facing Aircraft Installation

Follow the steps on pages 39-41, skipping the tether strap steps.

Do not risk your child's safety.

To keep your child as safe as possible, Dorel Juvenile Group strongly recommends replacing the car seat even after a minor crash; even if it was not occupied at the time.

Replacement After a Minor Crash

The National Highway Traffic Safety Administration states that for a crash to be considered minor **ALL of the following must be true:**

- Vehicle able to drive away from the crash site; **AND**
- Vehicle door nearest the car seat was not damaged; **AND**
- No passengers were injured; **AND**
- Airbags did not deploy; **AND**
- There is no visible damage to the car seat.

continued on next page

If the crash your car seat was involved in meets **ALL** the criteria, you may not need to replace the car seat.

If one or more of these criteria are not true or if you are uncertain of any of your answers, replace the car seat immediately.

Replacement After a Moderate to Severe Crash

You **must** replace this car seat if it has been in a moderate to severe car crash. This car seat is intended to protect a child in a single crash. During a crash, the car seat and all of its parts absorb crash energy which can deform or weaken it. Damage is not always visible. A damaged car seat must be replaced immediately.



Expiration

On the side of the child restraint there is a date of manufacture label as shown. Do not use this child restraint more than 8 years after the date of manufacture.



Never take your child out of the child restraint while the vehicle is moving.
Never leave child unattended.

Placing your child in a hot child restraint may result in burns.

Do not use a child restraint with damaged or missing parts.

Do not use a child restraint with cut, frayed or damaged harnesses.

Do not substitute parts or try to modify the child restraint in any way.

Do not lubricate buckles and fasteners.

Do not use any child restraint accessory except those approved by Dorel Juvenile Group.

Never allow any child to play with this child restraint; it is not a toy.

Do not remove or cover up any of the warning labels or other labels on the child restraint.

This child restraint has been certified for use in passenger vehicles. Do not use in a boat, on a motorcycle or in a cargo van or bus where there are no seat belts or tether anchors.

Read all instructions for additional warnings.



Installation in Vehicle

Check the vehicle belt or UAS belt before each use. Use only if the belt is tightened properly and locked securely in place.

Even when unoccupied, this child restraint must be firmly secured to the vehicle with a UAS belt or with the vehicle seat belt. In a crash or sudden stop, an unsecured child restraint could injure occupants.

Vehicle Seating Position



Never place a child rear-facing in a seating position with an active frontal air bag.

Check the vehicle owner's manual for more information about air bag/child restraint use.



Use the child restraint only on vehicle seats that face forward.



Do not use on seats that face the sides or rear of the vehicle.

For vehicles without a back seat, refer to your vehicle owner's manual.



Children are safer when properly restrained in rear seating positions than in the front seating positions.



According to accident statistics, children in rear seating positions are statistically safer, whether you have air bags, advanced air bags, or no air bags at all.

If you are not sure where to place the child restraint in your vehicle: consult your vehicle owner's manual; contact Dorel Juvenile Group Consumer Care Department; or visit your local Child Passenger Inspection Station.

To avoid your child being seriously burned, take the following precautions:

1. Park in the shade or where sun does not directly hit the child restraint.
2. Cover the child restraint with a sheet or blanket when not in use.

3. Check for hot seat and buckles before placing child in child restraint.

To help protect your vehicle seat's upholstery from damage, use a single layer towel underneath and behind child restraint.

Transport Canada Regulations

Transport Canada Road Safety Directorate regulates children's restraint systems under the Motor Vehicle Restraint Systems Safety Regulations (RSSR).

The regulations require the manufacturer and/or importer to certify the restraint to the applicable safety standards and place specified warnings and information on the labels fastened to each restraint and in this instruction manual.



Although child restraints are tested, evaluated, and certified by the manufacturer and tested by Transport Canada, it is possible that a safety-related problem may be found. If there is ever a safety issue with your child restraint, we use registration information to reach owners.

There are three additional ways to register your information:

Online: www.djgusa.com/registration/carseat/can

Telephone: 1-800-544-1108

Mail: Send your name, address and your child restraint's model number, manufacture date, line code, and date of purchase to:
Dorel Juvenile Canada Consumer Care Department 2855 Argentia Road, Unit 4
 Mississauga, ON L5N 8G6

Please do not send in your registration card if you have registered your child restraint online. For information on safety-related problems, you can also call Transport Canada's Road Safety Dept. at: 1-800-333-0371.

Tear Off and Mail This Part or Register Online. Détachez et poster cette partie ou enregistrez en ligne. 4259-4117E.

Consumer: Just fill in your name, address and email. Please print.
 Client: Simplement inscrire votre nom, adresse et courriel. S.V.P. imprimez.

Model Number **Line Code** **Manufacture Date**

Email / e-mail (optional) / Courriel (optionnel):

AB123CDE MAXI-COSI CARSEAT 2015/05/16

Date of Purchase / Date d'achat: L#11 B265035

Example of model number, line code and manufacture date.



If you don't have the card or if your address changes, you will find the model number, manufacture date, and line code on the label located on side of shell.

1. If the child restraint buckle or harness release lever sticks or you cannot get the straps tight enough around child:

DO NOT LUBRICATE. Check around lever and retractor for dropped food, sticky spilled drinks, dirt, leaves, etc. Clean with warm water and/or remove object with tweezers. If you cannot get the harness to adjust and remain tight with the buckle securely locked, do not use the child restraint.

2. If your harness twists:

Straighten the harness each time you put your child in the child restraint to help prevent twisting. Lock the buckle and tighten harness and it will be ready for next use.

Dorel Juvenile Group, Inc. (DJG) warrants this product to the original retail purchaser as follows:

This product is warranted against defective materials or workmanship for one year from the date of original purchase. **An original receipt is required to validate your warranty.**

DJG will, at its option, provide replacement parts or replace this product. DJG reserves the right to substitute if the part or model has been discontinued.

To make a claim under this warranty, please contact our Consumer Care Department by phone: 1-800-544-1108; text: 1-812-652-2525; or chat with us: www.coscokids.com.

Our hours of operation are from 8:00 a.m. to 6:00 p.m. EST Monday through Thursday and from 8:00 a.m. to 4:30 p.m. on Friday.

Proof of purchase is required and shipping charges are the responsibility of the consumer.

Warranty Limitations: This warranty does not include damages which arise from misuse or abuse of this product.

Limitation of Damages: The warranty and remedies as set forth are exclusive and in lieu of all others, oral or written, expressed or implied. In no event will DJG or the dealer selling this product be liable to you for any damages, including incidental or consequential damages, arising out of the use or inability to use this product.

This warranty gives you specific legal rights, and you may have other rights, which vary from state to state. Neither DJG nor the dealer selling this product authorized any person to create for it any other warranty, obligation, or liability in connection with this product.

Replacement Parts List

Buckle Assembly
 Harness Strap
 Seat Pad Set
 Chest Clip
 Tether Kit
 UAS Belt
 Instructions
 Locking Clip

**If requested color is not available,
 similar color will be substituted.**

**Applicable tax and shipping &
 handling will be added.**

For parts availability and questions,
 please call: 1-800-544-1108; text:
 1-812-652-2525; or chat with us:
www.coscokids.com

Hours of Operation:
 M-TH from 8:00 AM to 6:00 PM EST
 FRI from 8:00 AM to 4:30 PM EST

**If you already know which parts you
 need,** you may complete your order with a
 credit card by calling us at
 1-800-544-1108.

**See list for available parts. We accept
 Visa or MasterCard.**

Dorel Juvenile Group Information

Thank you for choosing this child restraint. The DJG family is committed to creating child restraints with the most comfort and convenience available today.

Remember, parents are a child's first teachers and examples. If you always buckle your seat belt, your child will think it is the natural thing to do. Make it a firm rule that the vehicle does not go until everyone is buckled up. Make no exceptions.

No one can predict if use of a child restraint will prevent injury or death in a particular crash. However, when combined with careful driving, proper use of a child restraint can lower a child's risk of injury or death in most crashes.

Your child's safety is worth the time it will take to read and follow these instructions. After reading, if you still have questions or have any concerns with this child restraint, please contact our Consumer Care Department:

Call: 1-800-544-1108

Text: 1-812-652-2525

Chat: www.coscokids.com

Hours of Operation:

M-TH from 8:00 AM to 6:00 PM EST

FRI from 8:00 AM to 4:30 PM EST