

COSCO®

SIMPLE

SMART

FUN



To see installation videos, scan the QR Code
or visit www.coscokids.com

SCENERA NEXT CONVERTIBLE CAR SEAT

Rear-Facing Mode: 5-40 lb (2.3-18 kg)
and 19-40 in. (48-101.6 cm)

Forward-Facing Mode: 22-40 lb
(10.1-18 kg) and 29-43 in. (73.6-110 cm)
and at least 1 year old

Max Seated Shoulder Height:
13.5 in. (34.3 cm)

**KEEP INSTRUCTIONS FOR FUTURE
USE.** Read all instructions before
using this car seat.

WARNING ⚠ Failure to follow the
warnings on the labels and in the
instruction manual can result in
serious injury or death to your child.

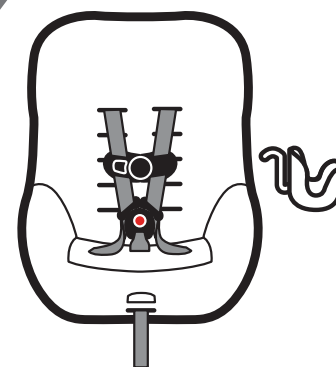

4358-7687 6.3.19

Overview

Welcome to the Cosco family and thank you for choosing this car seat, also known as a child restraint!

To help you get started using your child's new car seat, here are the 4 main tasks you'll need to complete:

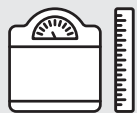

Measure Your Child



Adjust the Car Seat to Fit Your Child



Install the Car Seat into Your Vehicle

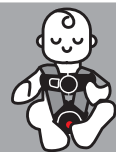

Secure Your Child in the Car Seat

Your child's safety is worth the time it will take for you to read and follow these instructions.

Ready? Let's go!

Pages 1-3 will introduce you to the parts of the car seat.

Page 68 has our contact information. If at any point you would like assistance, please feel free to reach out to us.

Quick Navigation

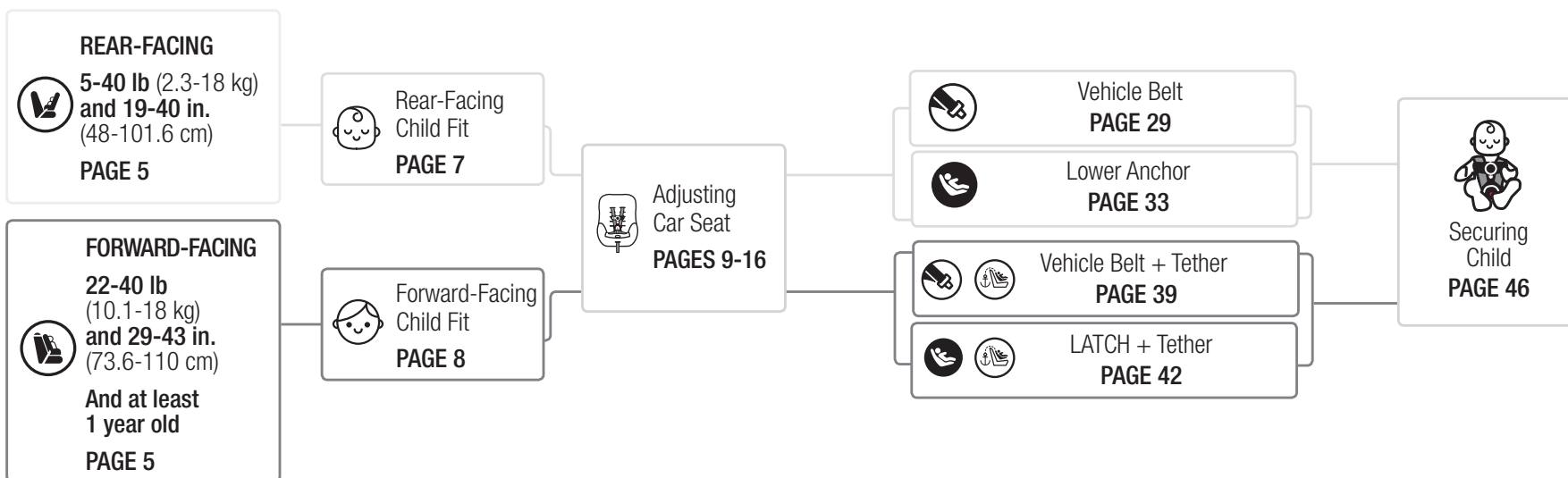

Contents

Getting Started

Parts of the Car Seat	1
Accessory Use	3
Choosing Car Seat Mode	4
Preparing Car Seat for Child Fit	6
Rear-Facing Child Fit	7
Forward-Facing Child Fit	8

Making Adjustments to Car Seat

Changing Buckle Position	9
Changing Shoulder Harness Strap Position	11
Harness System Adjustments for Smaller Infants	13

Choosing LATCH or Vehicle Belt

LATCH: Lower Anchor Use	17
Vehicle Belts	20
Tether Use	25

Installation in Vehicle

Rear-Facing Mode	27
Rear-Facing Vehicle Belt Install	29
Rear-Facing LATCH: Lower Anchor Install	33
Forward-Facing Mode	37
Forward-Facing Vehicle Belt + Tether Install	39
Forward-Facing LATCH: Lower Anchor + Tether Install	42

Securing Child in Car Seat 46

Car Seat Pad Use and Care

Removing Seat Pad for Cleaning	50
Removing Harness System	51
Installing Harness System	53

Safety Information

Aircraft Information	57
Replacement and Expiration of Car Seat	58
Child Restraint Use	60
Installation in Vehicle	61
Vehicle Seating Position	61
Registration and Safety Notices	63

Additional Information

Troubleshooting	64
Warranty	65
Replacement Parts List	67
Dorel Juvenile Group Information	68

1



Parts of the Car Seat

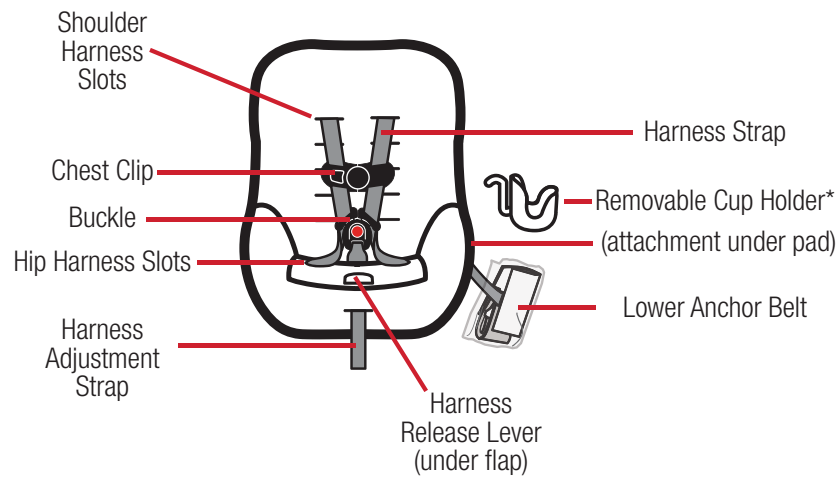

*See page 3 for Accessory Use.

2

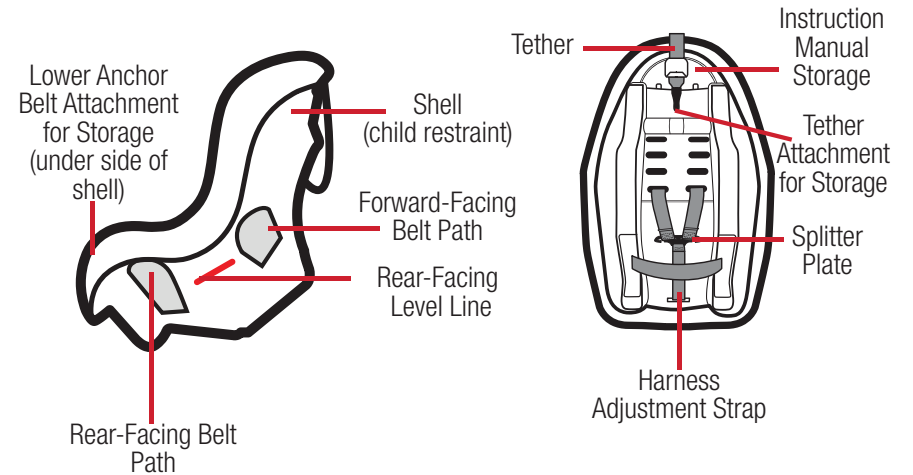



Accessory Use

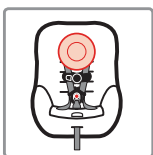

Head Pillow
(on select models)

To remove, from the back of the head

pillow gently pull the fabric tabs out from the shoulder harness slots.

To attach, slide the fabric tabs into shoulder harness slots.



Cup Holder

The cup holder can be attached to either side of the shell.

Pull pad off corner of shell. Align symbol on cup holder with symbol on shell.

Hook bottom of cup holder under edge of shell. Snap top of cup holder over edge of shell.

Replace pad.

The cup holder is dishwasher safe.

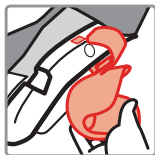

Choosing Car Seat Mode

⚠ Measure your child's weight and height (do not guess) before choosing the car seat's mode.

Your child's height, weight, and age determine how the car seat should be placed in the vehicle.

Children vary widely in body size, shape, and temperament—**please consult your doctor before switching between any of these modes within the limits and fit requirements of the seat.**

State Laws: Please be certain to follow your state's laws regarding car seat use.

American Academy of Pediatrics Recommendations

Infants and Toddlers: Should ride in a

rear-facing car seat as long as possible, until they reach the highest weight or height allowed by their seat.

Toddlers and Preschoolers: Once they are facing forward, children should use a forward-facing car seat with a harness for as long as possible, until they reach the height and weight limits for their seats.

School-Aged Children: Once they have outgrown their forward-facing car seat, children should use a belt-positioning booster seat until the vehicle's lap and shoulder seat belt fits properly. This is often when they have reached at least 4 feet 9 inches in height and are 8 to 12 years old.

continued on next page

Older Children: All children younger than 13 years should be restrained in the rear seats of vehicles for optimal protection.

REAR-FACING MODE

5-40 lb (2.3-18 kg) and 19-40 in. (48-101.6 cm)

Children under 1 year of age must ride **Rear-Facing**. In this car seat, your child can remain **Rear-Facing** until they outgrow any one of the following:

- **Weight Limit:** 40 lb (18 kg); **OR**
- **Height Limit:** 40 in. (101.6 cm); **OR**
- **Rear-Facing Child Fit** requirements, see page 7

FORWARD-FACING MODE

22-40 lb (10.1-18 kg) and 29-43 in. (73.6-110 cm)

Children must be at least 1 year of age to ride **Forward-Facing**.

In this car seat, your child can remain harnessed **Forward-Facing** until they outgrow any one of the following:

- **Weight Limit:** 40 lb (18 kg); **OR**
- **Height Limit:** 43 in. (110 cm); **OR**
- **Forward-Facing Child Fit** requirements, see page 8

Prepare Car Seat to Fit Your Child

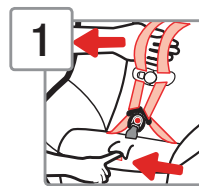

1

Fully Loosen Harness Straps

Push down on harness release lever (through opening in pad)

while pulling out on harness straps as shown.



2

Unbuckle Harness

Press in towards the **top** of the red button to release the buckle tongues.

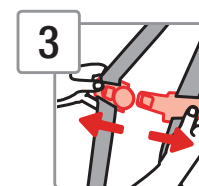

3

Release Chest Clip

Hold each side of the chest clip and press on the release button with your thumb and pull apart.

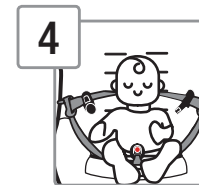

4

Place Child in Car Seat to Determine Proper Harness Fit

The child's bottom and back should be flat against the car seat.

For **Rear-Facing** child fit, see page 7

For **Forward-Facing** child fit, see page 8.



Rear-Facing Child Fit



Head Position

The top of your child's head **must be at least 1 in. (2.5 cm) below** the top of the car seat.



Buckle Position

Buckle must be used in either the **1st or 2nd slot**. Choose the slot closest to your child.

Do not use 3rd slot in Rear-Facing mode.

The buckle **should not be underneath or behind** your child.



Harness Strap Position

The harness strap **must be at or slightly below** shoulders; **never above**.

Need to make adjustments?

To change the buckle position, see pages 9-10.

To change harness strap position, see pages 11-12.

Forward-Facing Child Fit

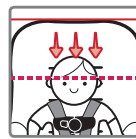

Head Position

The tops of your child's ears **must be below** the top of the car seat.

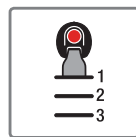

Buckle Position

Buckle can be used in **any slot**. Choose the slot closest to your child.

The buckle **should not be underneath or behind** your child.

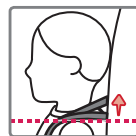

Harness Strap Position

The harness strap **must be at or slightly above** the shoulders; **never below**.



Max Seated Shoulder Height

In this car seat, the maximum seated shoulder height is **13.5 in. (34.3 cm)**.

To measure your child's seated shoulder height: have them sit on the floor with their back flat against a wall. Then measure from the floor up to the top of their shoulder.

Need to make adjustments?

To change the buckle position, see pages 9-10.

To change harness strap position, see pages 11-12.



Changing Buckle Postition

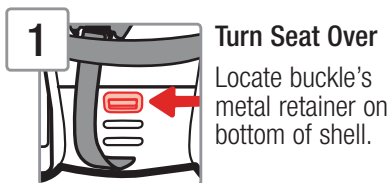

1 Turn Seat Over
Locate buckle's metal retainer on bottom of shell.

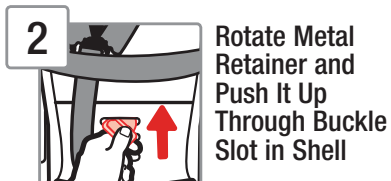

2 Rotate Metal Retainer and Push It Up Through Buckle Slot in Shell



3 From Top of Seat, Pull Buckle Out of Shell and Pad



4 Insert Buckle's Metal Retainer into Slot Closest to Child

Buckle **must** face out.

You **must** use the 1st or 2nd buckle slots when child restraint is used **Rear-Facing**. Any slot can be used when **Forward-Facing**.



5 Pull Buckle's Metal Retainer Completely Through Pad and Shell



6 Check Buckle
Pull up on buckle to make sure it is secured.
The buckle **must** not pull out.



Check your child's fit often.

If you cannot achieve a snug harness fit for your child, see pages 13-16.

To learn how to check harness tightness, see pages 46-49.

⚠ Failure to place buckle's metal retainer completely through pad and shell can result in serious injury or death.



Changing Shoulder Harness Strap Position

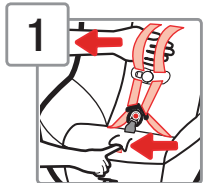

1 Fully Loosen Harness Straps

Push down on harness release lever (through opening in pad)

while pulling out on harness straps as shown.



2 From Back of Seat, Remove Harness Straps Loops From Splitter Plate

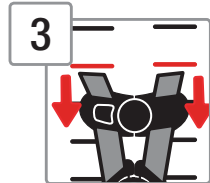

3 Pull Harness Straps Out of Shoulder Harness Slots

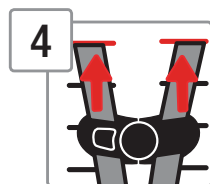

4 Rethread Harness Straps into Correct Shoulder Harness Slots For Your Child

For Rear-Facing child fit, see page 7.

For Forward-Facing child fit, see page 8.

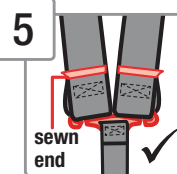

5 Attach Harness Strap Loops to Splitter Plate

Sewn ends of the harness strap loops **must** face towards you.

Do not twist harness straps or harness adjustment strap. Make sure the harness strap loops are fitted **completely** on both sides of the splitter plate.

Check your child's fit often.



If you cannot achieve a snug harness fit for your child, see pages 13-16.

To learn how to check harness tightness, see pages 46-49.

Check the harness straps often for any wear or damage.

⚠ Make sure the harness height is correct for your child's size.

Harness system must be installed correctly. Do not use a child restraint with damaged harness straps.

Failure to follow these warnings can result in serious injury or death.



If you cannot achieve a snug harness fit for your child, you may need to adjust the buckle strap and/or harness strap length as shown in this section.

Adjusting Buckle Strap

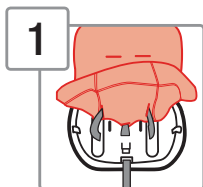

1 Pull Up Front of Seat Pad

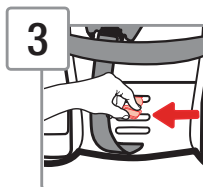

3 From Bottom of Seat, Pull Metal Retainer Towards You and Push It Up into Middle Slot As Shown



2 With Buckle in the 1st Slot As Shown, Turn the Seat Over
If you need to move the buckle to the 1st slot, see pages 9-10.

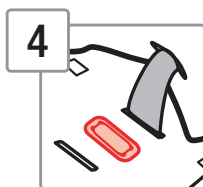

4 From Top of Seat, Lay the Metal Retainer Flat Against the Shell As Shown



Check Buckle

Pull up on buckle to make sure it is secured. The buckle **must** not pull out.

Check your child's fit often.

To learn how to check harness tightness, see pages 46-49.

Adjusting Harness Strap

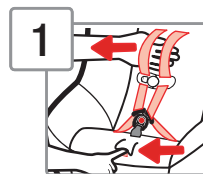

1 Fully Loosen Harness Straps



2 From Back of Seat, Remove Harness Strap Loops From Splitter Plate

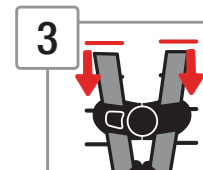

3 Pull Harness Straps Out of Shoulder Harness Slots

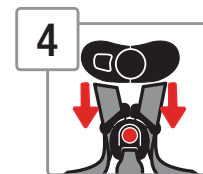

4 Unthread Chest Clip

continued on next page

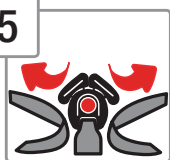

5

**Unthread Buckle**

Do not unbuckle the buckle.

6

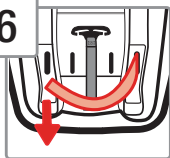

Lift Up Front of Seat Pad, Turn Seat Over and Pull Harness Strap Down and Out of Hip Harness Slot

7

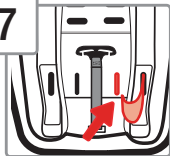

Weave Harness Strap In and Out of Shell as Shown

Harness strap goes behind buckle strap.

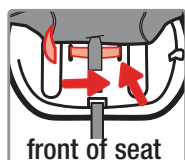

front of seat

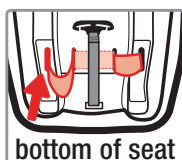

bottom of seat

8

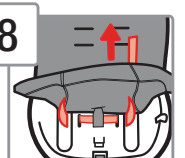

Thread Harness Strap Up Through Slot in Seat Pad

Replace seat pad around front of shell.

9

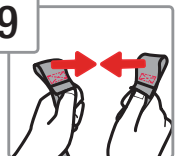

Make Harness Strap Even

Sewn ends of harness strap loops **must** face each other.

10

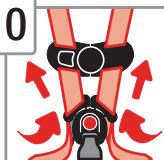

Thread Buckle and Chest Clip

Harness strap end goes through the **back** of buckle tongues and through the chest clip as shown.

front to back as

11

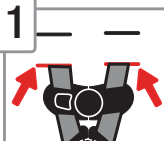

Thread Harness Strap Into Correct Shoulder Harness Slots for Your Child

12



Attach Harness Strap Loops to Splitter Plate

Sewn ends of the harness strap loops **must** face towards you.

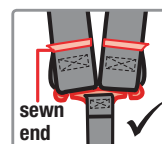

Do not twist harness strap or harness adjustment strap. Make sure the harness strap loops are fitted **completely** on both sides of the splitter plate.

on both sides of the splitter plate.

Check your child's fit often.

Check the harness straps often for any wear or damage.

⚠ WARNINGS: Harness system must be installed correctly. Do not use a child restraint with damaged harness straps.

Failure to follow these warnings can result in serious injury or death.



**For Use in Rear-Facing
or Forward-Facing Mode**

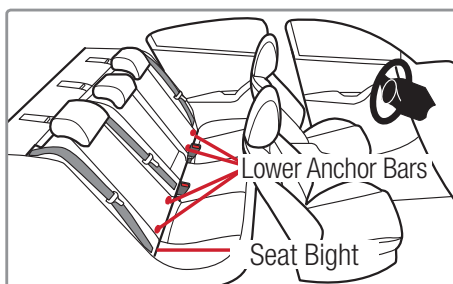

Your vehicle's features may be considerably different than those pictured here.

The lower anchors of LATCH (Lower Anchors and Tethers for CHildren) is a universal system for installing child restraints without using vehicle seat belts.

The lower anchor can **ONLY** be used in vehicles that have the lower anchor bars installed in designated seating positions. Most vehicles manufactured after September 2002 are equipped with lower anchor bars. Check your vehicle owner's manual to see which seating positions may be equipped with LATCH: lower anchor bars.

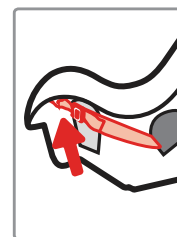
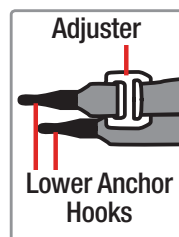

**To Remove Lower Anchor Belt from
Storage Location on Car Seat:**

Squeeze spring lever on hooks and
remove hooks from storage attachments.

**When installing this child restraint with
vehicle belts, the lower anchor hooks and
belt **MUST** be properly stored.**

⚠ WARNINGS

Do not use both the lower anchor belt and vehicle belt at the same time.

When used correctly the lower anchor belt or vehicle belts are equally safe.

continued on next page



To Remove Lower Anchor Belt from Vehicle Lower Anchor Bars:

Remove tension from the belt by pushing down on side of child restraint with the belt adjuster. Then press the adjuster button to loosen belt.

Unhook from anchor by squeezing spring lever on hook, pushing hook back into the seat bight, and twisting. Then pull it out of the vehicle seat.

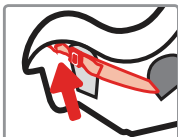

Storing Lower Anchor Belt:

When used Rear-Facing, thread lower anchor belt through **Forward-Facing Belt Path** as shown. Then attach hooks to attachments near **Rear-Facing Belt Path** as shown. Gently pull free end of belt to remove slack.



When used Forward-Facing, thread lower anchor belt through **Rear-Facing Belt Path**. Then attach hooks to attachments near **Rear-Facing Belt Path** as shown. Gently pull free end of belt to remove slack.

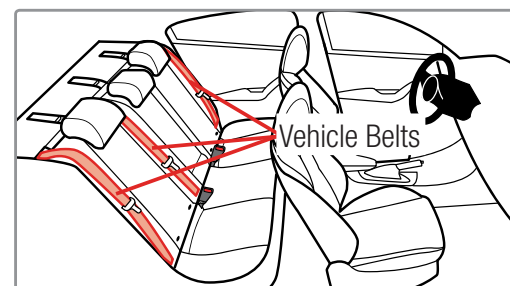

Your vehicle's features may be considerably different than those pictured here.

If lower anchors are not an option you must use the vehicle seat belt system to install the child restraint.

Not all vehicle belts and seating positions will work with child restraints. Please go through the following steps to understand how to lock a child restraint in Rear-Facing or Forward-Facing mode with a vehicle belt.

continued on next page



1

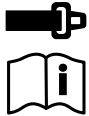

You MUST Review Your Vehicle Owner's Manual

Your vehicle owner's manual will let you know what vehicle belts and seating positions child restraints can be installed in.

2



Determine How the Child Restraint Will Be Locked Into Place

The vehicle belt **must not** loosen after tightening.

This means there needs to be a way to lock the vehicle belt.

The ways this can be done are:

- By using the seat belt's retractor; or
- By using the seat belt's latch plate.

3

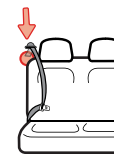

Check the Retractor

Retractors pull seat belts into stored positions and lock the belt to hold passengers in place.

A retractor is most likely how you will be locking a child restraint into place.

See the following "Types of Retractors" section for some common types of vehicle belt retractors that will work with this child restraint.



Types of Retractors

Switchable Retractor
(most vehicles have this type)



This retractor can be switched to a locking mode. You **must** have the retractor in the locking mode to use the seat belt with this child restraint.

Switching to locking mode: Slowly pull the shoulder belt all the way out, then let it go back in an inch or two.

As it goes back in, you will most likely hear a ratcheting sound.

Gently pull the belt to see if it has locked. You will not be able to pull any more belt out if the lock has engaged.

continued on next page



Automatic Locking Retractor



This retractor always locks.

It will automatically lock after slowly pulling the seat belt out at least halfway and letting the belt go back into the retractor an inch or two.

Emergency Locking Retractor

See Step 4
“Check the Latch Plates”

If the retractor does not lock, it is most likely an Emergency Locking Retractor. These retractors only lock during a sudden stop or collision.

You will need to determine if your seat belt's latch plate can lock the belt. See Step 4, “Check the Latch Plates”.

4



Check the Latch Plates

Latch plates are the part of the seat belt that goes into the buckle.

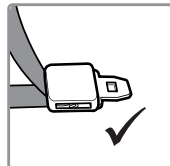

Locking Latch Plate

Hold the lap belt with one hand and with your other hand grasp the tongue of the latch plate (the part that goes inside the buckle).

Pull the latch plate straight out in line with the lap belt.

If the latch plate does not slide up and down the vehicle belt, it is a **locking latch plate**.

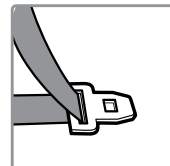

Emergency Locking Retractor with a Sliding Latch Plate

If the latch plate slides up and down the vehicle belt, it is a **sliding latch plate**.

Sliding latch plates easily slip between the lap and shoulder portions of the belt.

If you have an Emergency Locking Retractor with a Sliding Latch Plate, you must use a locking clip.

Please contact us for one. See page 67.

Never Use With This Child Restraint

Emergency Locking Retractor Lap Only Belt



Inflatable Seat Belts





For Forward-Facing Mode Only

Your vehicle's features may be considerably different than those pictured here.

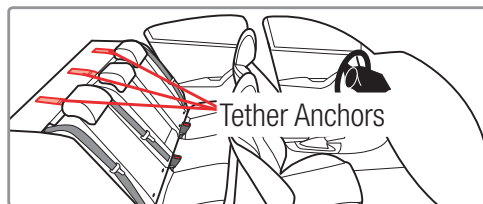

You **must always attach, adjust, and secure the top anchorage (tether) strap** when installing the child restraint forward-facing with internal harness. Tethers improve the installation and stability of child restraints and reduce the risk of injury. Attach the tether hook to the tether anchor designated by your vehicle manufacturer for that seating position. Check your vehicle owner's manual for more information. If the seating position does not have a tether anchor, use a different seating position or see your dealer or a qualified mechanic and have one installed.

⚠ Using this child restraint without the tether strap anchored as required by the manufacturer would be a misuse of the child restraint and, in a sudden stop or crash, could result in serious injury or death. Do not fasten multiple tether hooks on the same tether anchor in the vehicle.

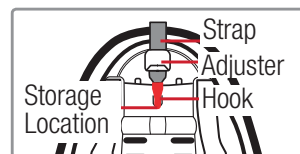

Tether Storage and Parts

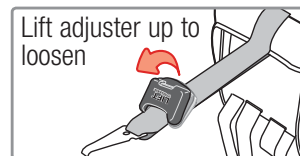
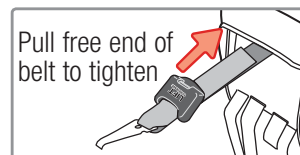

Storing Tether Strap

When installing rear facing or when not in use, attach the tether hook to its storage attachment on the back of the shell as shown.

Gently tighten to remove slack.

Adjusting Tether Strap

To tighten: After the child restraint is locked into place with the lower anchor belt or vehicle belt, push down on child restraint and gently pull on free end of tether strap.

To loosen: Lift up on tether adjuster and push it towards tether hook.



Rear-Facing Mode

5-40 lb (2.3-18 kg) and 19-40 in. (48-101.6 cm)



Lower Anchor Belt



Lap Belt

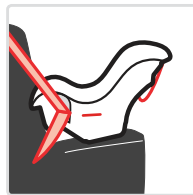

Lap/Shoulder Belt



Never install a rear-facing child restraint in the front seat of a vehicle equipped with an active frontal airbag.

Do not use the tether for rear-facing mode. Secure the tether strap hook to its storage attachment.

Do not use the lower anchor belt along with the vehicle lap or lap/shoulder belt.

Check the vehicle belt or the lower anchor belt before each use. Use only if the belt can be tightened properly and locked securely in place.

Do not fasten multiple lower anchor hooks on the same lower anchor bar in the vehicle.

This child restraint must always face the rear of the vehicle until the child is at least 1 year old and weighs 22 lb (10 kg).



Rear-Facing Vehicle Belt Install

Before you begin installing the seat into your vehicle, did you check:

Your child's weight and height?

**5-40 lb (2.3-18 kg) and
19-40 in. (48-101.6 cm)**

Your child's fit? See page 7.

Do you need to make adjustments to the harness height or the buckle position?

1



Place Child Restraint Rear Facing in Back Seat

2



Check Level Line

The level line on shell **must** be parallel with the ground.

3



Check if Your Vehicle Belts Will Work With This Child Restraint

This is very important because **not all vehicle belts will work with child restraints.** Review pages 20-24 and your vehicle owner's manual to determine what kind of vehicle belt you have and how to lock a child restraint in place.

4

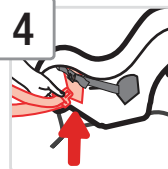

Route the Vehicle Belt

Thread the vehicle belt into the **Rear-Facing Belt Path** opening.

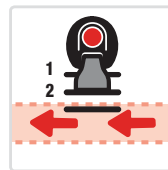

Pull it across the seat, under the seat pad, in front of the buckle, and out through the other **Rear-Facing Belt Path** opening.

Do not twist belt.

5

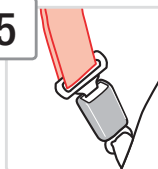

Buckle the Vehicle Belt

6

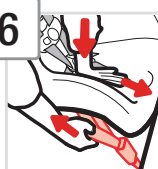

Tighten Belt

Place hand in child restraint.

Firmly push child restraint down and

back towards the vehicle seat back while pulling shoulder belt or the free end of lap belt to tighten.

continued on next page



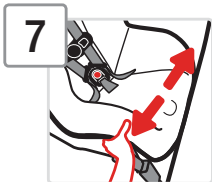

7 Check Belt Tightness

Hold child restraint at the belt path with your weakest hand. Push and pull from side to side.

It should not move more than 1 in. (2.5 cm). **If it moves more than 1 in. (2.5 cm), you can try:**

- A. Pulling the belt tighter.
- B. Reinstalling the child restraint.
- C. Changing to a different seating location.
- D. Switching to the lower anchor belt installation if lower anchors are available in your vehicle.

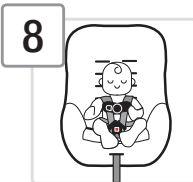

8

Secure Child in Child Restraint

See pages 46-49.

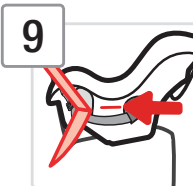

9

Recheck Level Line

Redo the installation if the level line is not parallel with the ground.

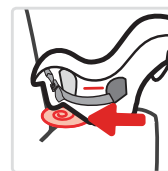

NOTE: You may need to place a tightly rolled towel(s) or foam pool noodle(s) under front of child restraint to help achieve the correct recline angle.

Check often to be sure padding is still in place and the belt is tight.

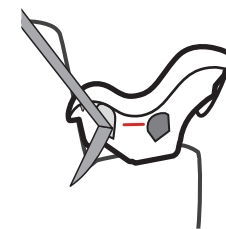

Finished!

Check the tightness of the install often to make sure it has not loosened.



Before you begin installing the seat into your vehicle, did you check:

Your child's weight and height?

**5-40 lb (2.3-18 kg) and
19-40 in. (48-101.6 cm)**

Your child's fit? See page 7.

Do you need to make adjustments to the harness height or the buckle position?

1



Remove Lower Anchor Belt from Storage Location

Remove it from the rear-facing belt path so both hooks are on the same side of the seat as shown.

2



Locate Rear-Facing Belt Path and Route Lower Anchor Belt Through It

The lower anchor belt adjuster can be on either side.

3

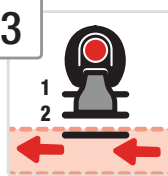

Reach Under Pad and Pull Hook Across to Opposite Side

Pull it across the seat, under the seat pad, in front of the buckle, and out through the other **Rear-Facing Belt Path** opening. **Do not twist belt.**

4



Finished Lower Anchor Belt Routing

5



Place Child Restraint Rear Facing in Back Seat

6

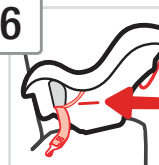

Check Level Line

The level line on shell **must** be parallel with the ground.

7



Attach Lower Anchor Hooks to Vehicle's Lower Anchors

Review your vehicle owner's manual for lower anchor locations and lower anchor belt use.

Repeat for other side the car seat.

continued on next page



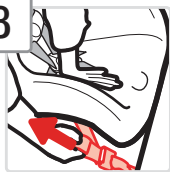

8

**Tighten Belt**

Place hand in child restraint.

Firmly push child restraint down and back towards the vehicle seat back while pulling free end of belt to tighten.



It may be easier to pull pad away from shell and tighten the belt through the belt path opening as shown.

9

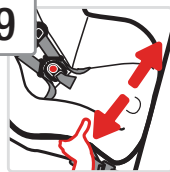
**Check Belt Tightness**

Hold child restraint at the belt path with your weakest hand. Push and pull from side to side. It should not move more than 1 in. (2.5 cm).

pull from side to side. It should not move more than 1 in. (2.5 cm).

If it moves more than 1 in. (2.5 cm), you can try:

- A. Pulling the belt tighter.
- B. Reinstalling the child restraint.
- C. Changing to a different seating location.
- D. Switching to vehicle belt installation.

10

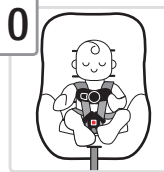
**Secure Child in Child Restraint**

See pages 46-49.

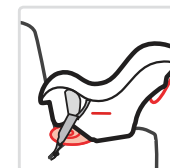

NOTE: You may need to place a tightly rolled towel(s) or foam pool noodle(s) under front of child restraint to help make level line parallel with the ground.

Check often to be sure padding is still in place and the belt is tight.

11

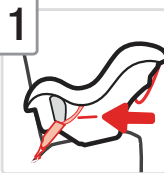
**Recheck Level Line**

Redo the installation if the level line is not parallel with the ground.

**Finished!**

Check the tightness of the install often to make sure it has not loosened.



**22-40 lb (10.1-18 kg) and 29-43 in. (73.6-110 cm)
and at least 1 year old**



Lower Anchor
Belt with Tether

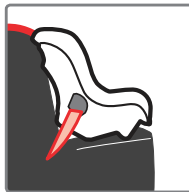

Lap Belt
with Tether

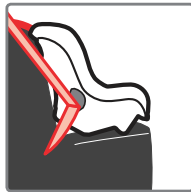

Lap/Shoulder
Belt with Tether



Do not use the lower anchor belt along with the vehicle lap or lap/shoulder belt.

Check the vehicle belt or the lower anchor belt before each use. Use only if the belt can be tightened properly and locked securely in place.

Do not fasten multiple lower anchor connectors on the same lower anchor bar in the vehicle.

In this child restraint your child must be at least 1 year old and weigh 22 lb (10 kg) before they sit forward-facing.



Before you begin installing the seat into your vehicle, did you check:

Your child's weight and height?

**22-40 lb (10.1-18 kg) and
29-43 in. (73.6-110 cm)**

Your child's fit? See page 8.

Do you need to make adjustments to the harness height or the buckle position?

1

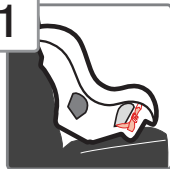

Place Child Restraint Forward-Facing Flush Against Vehicle Seat Back

2

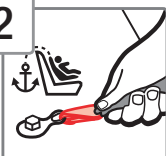

Loosely Attach Tether Hook

Check vehicle owner's manual for specific location.

3



Check if Your Vehicle Belts Will Work With This Child Restraint

This is very important because

not all vehicle belts will work with child restraints. Review pages 20-24 and your vehicle owner's manual to determine what kind of vehicle belt you have and how to lock a child restraint in place.

4

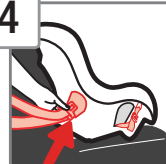

Locate the Forward-Facing Belt Path and Route the Vehicle Belt Through It

Thread the vehicle belt through the **Forward-Facing Belt Path** opening. Pull it across the seat. Then thread it through the other **Forward-Facing Belt Path** opening. **Do not twist belt.**

5

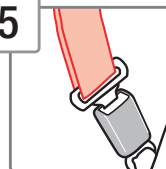

Buckle the Vehicle Belt

6



Tighten Tether

Push firmly on the back of the seat and pull the tether strap to remove all slack and create tension on the strap.

7

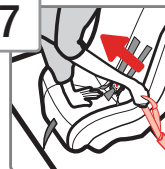

Tighten Belt

Place hand in child restraint.

Firmly push down while pulling shoulder belt or the free end of lap belt to tighten.

continued on next page





8

**Check Belt Tightness**

Hold child restraint at the belt path with your weakest hand.

Push and pull from side to side. It should not move more than 1 in. (2.5 cm).

If it moves more than 1 in. (2.5 cm), you can try:

- A. Putting your knee in the seat and pulling the belt tighter.
- B. Reinstalling the child restraint.
- C. Changing to a different seating location.
- D. Switching to the lower anchor belt installation if lower anchors are available in your vehicle.

**Finished!**

Check the tightness of the install often to make sure it has not loosened.

**Securing Child in Car Seat**

To properly secure your child in the car seat, see pages 46-49.

Check your child's fit often and make any needed adjustments to the car seat as they grow.



Before you begin installing the seat into your vehicle, did you check:

Your child's weight and height?

**22-40 lb (10.1-18 kg) and
29-43 in. (73.6-110 cm)**

Your child's fit? See page 8.

Do you need to make adjustments to the harness height or the buckle position?

1

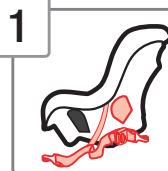
**Remove Lower Anchor Belt from Storage Location**

Remove it from the rear-facing belt path so both hooks are on

the same side of the seat as shown.

2



Locate the Forward-Facing Belt Path and Route the Lower Anchor Belt Through It

Pull it across the seat. Then thread it through the other **Forward-Facing Belt Path** opening.

Do not twist belt.

The lower anchor belt adjuster can be on either side of the car seat.

continued on next page

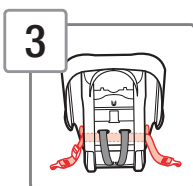

3 Finished Lower Anchor Belt Routing

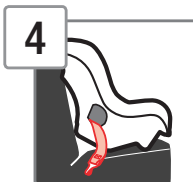

4 Place Child Restraint Forward Facing Flush Against Vehicle Seat Back

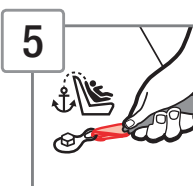

5 Loosely Attach Tether Hook
Check vehicle owner's manual for specific location.

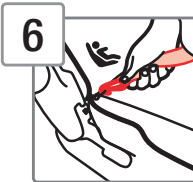

6 Attach Lower Anchor Hooks to Vehicle's Lower Anchors
Review your vehicle owner's manual for lower anchor locations and lower anchor belt use.

Repeat for other side the car seat.

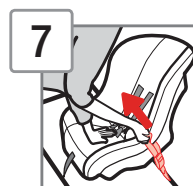

7 Tighten Belt
Place hand in child restraint.
Firmly push down while pulling free end of belt to tighten.

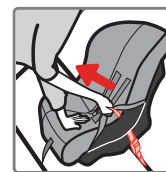

It may be easier to pull back the pad and pull the free end of the belt parallel with the belt path as shown.

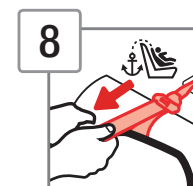

8 Tighten Tether
Push firmly on the back of the seat and pull the tether strap to remove all slack and create tension on the strap.

continued on next page



9

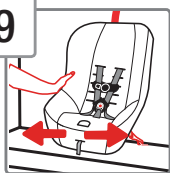

Check Belt Tightness

Hold child restraint at the belt path with your weakest hand.

Push and pull from side to side. It should not move more than 1 in. (2.5 cm).

If it moves more than 1 in. (2.5 cm), you can try:

- A. Putting your knee in the seat and pulling the belt tighter.
- B. Reinstalling the child restraint.
- C. Changing to a different seating location.
- D. Switching to vehicle belt installation.



Finished!

Check the tightness of the install often to make sure it has not loosened.



Securing Child in Car Seat

To properly secure your child in the car seat, see pages 46-49.

Check your child's fit often and make any needed adjustments to the car seat as they grow.

Securing Child in Car Seat



1

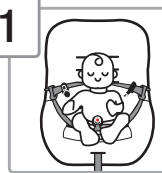

Place Child in Car Seat

The child's bottom and back should be flat against the car seat.

Position harness strap over child's shoulders and upper thighs.

3

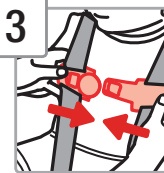

Close Chest Clip

Insert right half of chest clip into left half and snap together.

2



Buckle Harness

Push buckle tongues into buckle until you hear a "click".

Pull up on harness strap to make sure buckle is locked.

4

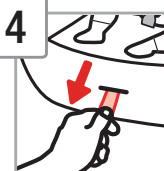

Tighten Harness

Pull on harness adjustment strap to tighten harness snugly.

continued on next page



5



Position Chest Clip

Slide the chest clip up the harness straps and position it at mid-chest (even with armpits) and away from the child's neck.

6



Check Harness Tightness

Try to pinch the harness at the shoulders vertically between index finger and thumb as shown.

If your fingers slip off, the harness is tight enough.

If you can pinch the harness strap, tighten more. The harness strap should be snug throughout its length.

A snug strap should not allow any slack. It lies in a relatively straight line without sagging. It does not press on the child's flesh or push the child's body into an unnatural position.

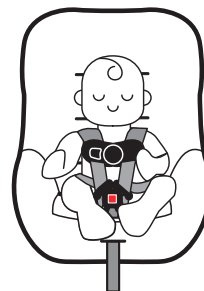

Finished!

The child is now secured in the car seat. Check your child's fit often and make any needed adjustments to the car seat as they grow.

To Remove Child from Car Seat:

1. Loosen Harness Strap
2. Unbuckle Harness
3. Release Chest Clip
4. Remove Child

continued on next page



⚠ WARNINGS: Failure to fasten and tighten the harness system correctly may allow the child to be ejected from the child restraint in a crash or sudden stop causing serious injury or death.

Do not mistake comfort for safety. Harness system must be snugly adjusted.



Bulky clothing can prevent the harness straps from being tightened properly.

DO NOT put snowsuits or bulky garments on your child when placing them in the child restraint.

Removing Seat Pad for Cleaning

You must remove the harness system to remove the pad from the shell. See pages 51-52.

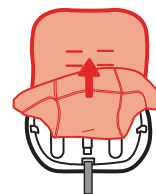

Remove Pad

Pull pad off the bottom of child restraint and remove pad.

Cleaning Pad

Machine wash separately with cold water on a gentle cycle. Do not use bleach. Tumble dry separately for 10-12 minutes on low heat. Remove immediately.

Cleaning Harness Strap

Check the harness straps often for any wear or damage.

Spot clean using warm sudsy water and damp cloth. Spilled food and liquids on the child restraint may result in mold or bacterial growth over time. These spills could also attract insects or rodents.

Replacing Pad

Starting from bottom of child restraint, slip pad on shell. Pull harness adjustment strap through pad. Wrap pad around the top of shell. Install harness system, see pages 53-56.

⚠ WARNINGS: Do not use child restraint without the seat pad or with damaged harness straps. Failure to do this can result in serious injury or death.

Removing Harness System

Only remove the harness system to clean the seat pad.

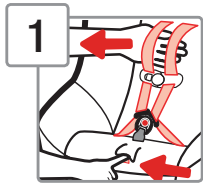

1 Fully Loosen
Harness Straps

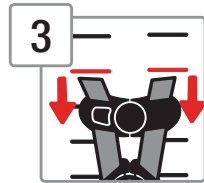

3 Pull Harness
Strap Out
of Shoulder
Harness Slots

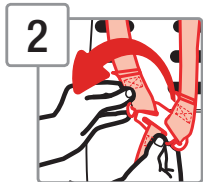

2 From Back of
Seat, Remove
Harness Strap
Loops From
Splitter Plate

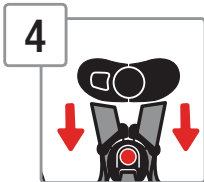

4 Unthread
Chest Clip

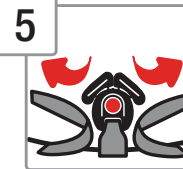

5 Unthread Buckle
Do not unbuckle
the buckle.

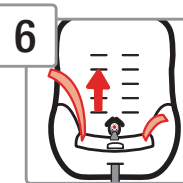

6 Pull Harness
Strap Out of Seat



7 Turn Seat Over
Locate buckle's
metal retainer on
bottom of shell.

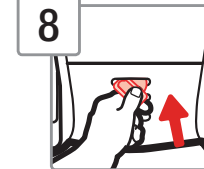

8 Rotate Metal
Retainer and
Push It Up
Through Shell
and Pad



9 From Top of Seat,
Pull Buckle Out
of Shell

Installing Harness System

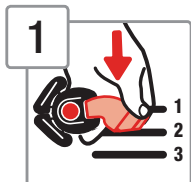

1 Insert Buckle's Metal Retainer into Slot Closest to Child

Buckle **must** face out. You **must** use the 1st or 2nd buckle slots when child restraint is used rear facing. Any slot can be used when forward facing.

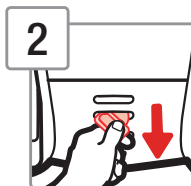

2 Pull Metal Retainer Completely Through Pad and Shell



3 Check Buckle

Pull up on buckle to make sure it is secured.

The buckle **must** not pull out.

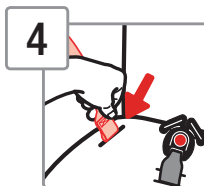

4 Rethread Harness Strap

With sewn end of harness strap loop facing the buckle, thread harness strap

down through hip harness slot.

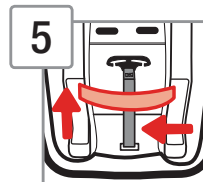

5 Pull Harness Strap Across Bottom of Shell

Harness strap **must** lie in front of harness adjustment

strap as shown. Push harness strap up through other hip harness slot.

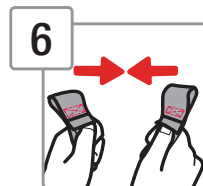

6 Make Harness Strap Even

Sewn ends of harness strap loops **must** face each other.



7 Thread Buckle and Chest Clip

Harness strap ends go through the **back** of buckle tongues and through the chest clip **front to back** as shown.

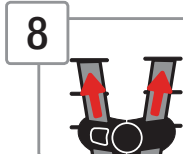

8 Thread Harness Straps Into Correct Shoulder Harness Slots For Your Child

For Rear-Facing

child fit, see page 7.

For Forward-Facing child fit, see page 8.

continued on next page

9



Attach Harness Strap Loops to Splitter Plate

Sewn ends of the harness strap loops **must** face towards you.

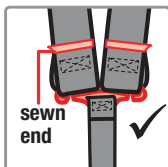

Do not twist harness strap or harness adjustment strap.

Make sure the harness strap loops are fitted **completely on** both sides of the splitter plate.

Check your child's fit often.

If you cannot achieve a snug harness fit for your child, you may need to adjust the harness system.

See pages 13-16.

To learn how to check harness tightness, see pages 46-49.

Check the harness straps often for any wear or damage.

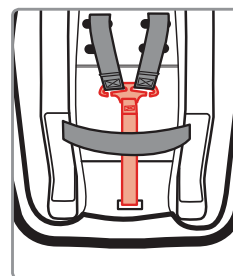

⚠ WARNINGS: Failure to place harness adjustment strap behind the harness strap as shown can result in serious injury or death.

Harness system must be installed correctly.

Do not use a child restraint with damaged harness straps.

Failure to follow these warnings can result in serious injury or death.



Aircraft Information

This restraint is certified for aircraft use.

Install the child restraint in a window seat to avoid blocking the aisle. If the aircraft lap belt is too short, ask the flight attendant for a belt extender.

Use only on forward facing aircraft seats. Contact the airline for their specific policies.

Some airlines may ask to see a label stating that this child restraint is certified for aircraft use.



There is an airplane certification label located on the side of this child restraint as shown.

⚠ WARNING: Store lower anchor belt and tether strap when installing with aircraft belts.

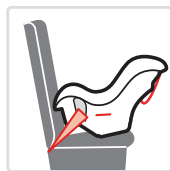

Rear Facing Aircraft Installation

Follow the steps on pages 29-32.



Forward Facing Aircraft Installation

Follow the steps on pages 39-41, skipping the tether strap steps.

Replacement and Expiration of Car Seat

Do not risk your child's safety.

To keep your child as safe as possible, Dorel Juvenile Group strongly recommends replacing the car seat even after a minor crash; even if it was not occupied at the time.

Replacement After a Minor Crash

The National Highway Traffic Safety Administration states that for a crash to be considered minor **ALL of the following must be true:**

- Vehicle able to drive away from the crash site; **AND**
- Vehicle door nearest the car seat was not damaged; **AND**
- No passengers were injured; **AND**
- Airbags did not deploy; **AND**
- There is no visible damage to the car seat.

continued on next page

If the crash your car seat was involved in meets **ALL** the criteria, you may not need to replace the car seat.

If one or more of these criteria are not true or if you are uncertain of any of your answers, replace the car seat immediately.

Replacement After a Moderate to Severe Crash

You **must** replace this car seat if it has been in a moderate to severe car crash. This car seat is intended to protect a child in a single crash. During a crash, the car seat and all of its parts absorb crash energy which can deform or weaken it. Damage is not always visible. A damaged car seat must be replaced immediately.



Expiration

On the side of the child restraint there is a date of manufacture label as shown. Do not use this child restraint more than 8 years after the date of manufacture.



Never take your child out of the child restraint while the vehicle is moving.

Never leave child unattended.

Placing your child in a hot child restraint may result in burns.

Do not use a child restraint with damaged or missing parts.

Do not use a child restraint with cut, frayed or damaged harnesses.

Do not substitute parts or try to modify the child restraint in any way.

Do not lubricate buckles and fasteners.

Do not use any child restraint accessory except those approved by Dorel Juvenile Group.

Never allow any child to play with this child restraint; it is not a toy.

Do not remove or cover up any of the warning labels or other labels on the child restraint.

This child restraint has been certified for use in passenger vehicles. Do not use in a boat, on a motorcycle or in a cargo van or bus where there are no seat belts or tether anchors.

Read all instructions for additional warnings.



Installation in Vehicle

Check the vehicle belt or lower anchor belt before each use. Use only if the belt is tightened properly and locked securely in place.

This child restraint should be securely belted in the vehicle even when not in use. In a crash or sudden stop, an unsecured child restraint could injure occupants.

Vehicle Seating Position



Never place a child rear-facing in a seating position with an active frontal air bag.

Check the vehicle owner's manual for more information about air bag/child restraint use.



Use the child restraint only on vehicle seats that face forward.



Do not use on seats that face the sides or rear of the vehicle.

For vehicles without a back seat, refer to your vehicle owner's manual.



Children are safer when properly restrained in rear seating positions than in the front seating positions.

According to accident statistics, children in rear seating positions are statistically safer, whether you have air bags, advanced air bags, or no air bags at all.

If you are not sure where to place the child restraint in your vehicle: consult your vehicle owner's manual; contact Dorel Juvenile Group Consumer Care Department; or visit your local Child Passenger Inspection Station. Go to <http://www.safercar.gov/cpsApp/cps/index.htm>

to find your closest station.

To avoid your child being seriously burned, take the following precautions:

1. Park in the shade or where sun does not directly hit the child restraint.
2. Cover the child restraint with a sheet or blanket when not in use.
3. Check for hot seat and buckles before placing child in child restraint.

To help protect your vehicle seat's upholstery from damage, use a single layer towel underneath and behind child restraint.



Please complete the postage-paid registration card that came with your child restraint, and send it to us. Child restraints could be recalled for safety reasons. You must register this restraint to be reached in a recall. Send your name, address, e-mail address if available and the restraint's model number and manufacturing date to:

Dorel Juvenile Group, Inc.
Consumer Care Department
 PO Box 2609
 Columbus, IN 47202-2609

or call 1-800-544-1108 or register online at www.djgusa.com/registration/carseat/us.

For recall information, call the U.S. Government's Vehicle Safety Hotline at 1-888-327-4236 (TTY: 1-800-424-9153), or go to <http://www.NHTSA.gov>.

Consumer - Just fill in your name, address and email. Please print (use dark ink).

Your Name _____

Your Street Address _____

Your Email Address _____

Model Number **Line Code** **Manufacture Date**

Model Number: BC098-BVM Line Code: COSCO SCENERA NEXT Manufacture Date: 01/22/2015

Barcode: L#11 B265035

Example of model number, line code and manufacture date.



If you don't have the card or if your address changes, you will find the model number, manufacture date, and line code on the label located on side of shell.

1. If the child restraint buckle or harness release lever sticks or you cannot get the straps tight enough around child:

DO NOT LUBRICATE. Check around lever and retractor for dropped food, sticky spilled drinks, dirt, leaves, etc. Clean with warm water and/or remove object with tweezers. If you cannot get the harness to adjust and remain tight with the buckle securely locked, do not use the child restraint.

2. If your harness twists:

Straighten the harness each time you put your child in the child restraint to help prevent twisting. Lock the buckle and tighten harness and it will be ready for next use.

Dorel Juvenile Group, Inc. (DJG) warrants this product to the original retail purchaser as follows:

This product is warranted against defective materials or workmanship for one year from the date of original purchase. **An original receipt is required to validate your warranty.** DJG will, at its option, provide replacement parts or replace this product. DJG reserves the right to substitute if the part or model has been discontinued.

To make a claim under this warranty, please contact our Consumer Care Department by phone: 1-800-544-1108; text: 1-812-652-2525; or chat with us: www.coscokids.com. Our hours of operation are from 8:00 a.m. to 6:00 p.m. EST Monday through Thursday and from 8:00 a.m. to 4:30 p.m. on Friday.

Proof of purchase is required and shipping charges are the responsibility of the consumer.

Warranty Limitations: This warranty does not include damages which arise from misuse or abuse of this product.

Limitation of Damages: The warranty and remedies as set forth are exclusive and in lieu of all others, oral or written, expressed or implied. In no event will DJG or the dealer selling this product be liable to you for any damages, including incidental or consequential damages, arising out of the use or inability to use this product.

Limitation of warranties and other warranty terms and state law rights:

Any implied warranties, including implied warranties of the merchantability and fitness for a particular purpose, shall be limited to the duration and terms of the express written warranty. Some states do not allow limitations as to how long an implied warranty lasts or the exclusion or limitation of incidental or consequential damages, so the above limitations may not apply to you.

This warranty gives you specific legal rights, and you may have other rights, which vary from state to state. Neither DJG nor the dealer selling this product authorized any person to create for it any other warranty, obligation, or liability in connection with this product.

Replacement Parts List

If requested color is not available, similar color will be substituted. Prices are subject to change. Applicable tax and shipping & handling will be added.

Part	Cost
Buckle Assembly	\$7.99
Harness Strap	\$2.99
Seat Pad Set	\$24.00
Chest Clip	\$1.50
Tether Kit	\$6.50
Lower Anchor Belt.....	\$17.99
Instructions	\$0.00
Locking Clip	\$2.50

For parts availability and questions, please call: 1-800-544-1108; text: 1-812-652-2525; or chat with us: www.coscokids.com

Hours of Operation:

M-TH from 8:00 AM to 6:00 PM EST
FRI from 8:00 AM to 4:30 PM EST

If you already know which parts you need, you may complete your order with a credit card by calling us at 1-800-544-1108.

See list for available parts. We accept Visa or MasterCard.

Dorel Juvenile Group Information

Thank you for choosing this child restraint. The DJG family is committed to creating child restraints with the most comfort and convenience available today. Remember, parents are a child's first teachers and examples. If you always buckle your seat belt, your child will think it is the natural thing to do. Make it a firm rule that the vehicle does not go until everyone is buckled up. Make no exceptions.

No one can predict if use of a child restraint will prevent injury or death in a particular crash. However, when combined with careful driving, proper use of a child restraint can lower a child's risk of injury or death in most crashes.

Your child's safety is worth the time it will take to read and follow these instructions. After reading, if you still have questions or have any concerns with this child restraint, please contact our Consumer Care Department:

Call: 1-800-544-1108

Text: 1-812-652-2525

Chat: www.coscokids.com

Hours of Operation:

M-TH from 8:00 AM to 6:00 PM EST

FRI from 8:00 AM to 4:30 PM EST